

Sure-Flex™ PVC/KEE HP

Mechanically Fastened Metal Retrofit

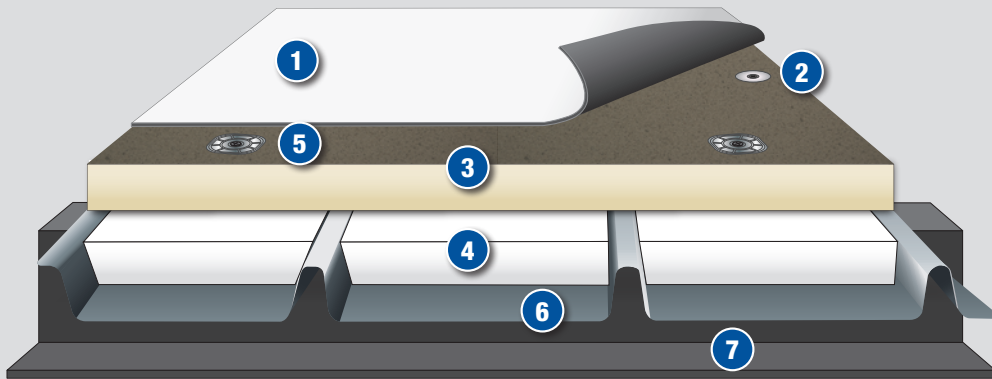

- 1 Sure-Flex PVC or KEE HP Reinforced Membrane
- 2 Induction Welding Plates
- 3 Acceptable Insulation
- 4 Flute Filler
- 5 Insulation Fasteners and Plates
- 6 Existing Metal Roof
- 7 Structural Purlin

Sure-Flex PVC and KEE HP Membranes for Metal Retrofit Systems:

Color	PVC: White, Gray, Tan, Light Gray, Slate Gray KEE HP: White, Gray, Tan, and Light Gray
Thicknesses (mils)	50, 60, and 80
Standard Widths	10', 81", 5', 40.5"
Standard Lengths	50-mil – 100' 60-mil – 100' 80-mil – 75'

System Features & Benefits:

- » Adds insulating value
- » Heat-weldable seams
- » Roofing membrane is CRRC rated, and can contribute to LEED® requirements
- » Excellent wind uplift performance
- » Industry-leading PVC and KEE HP membranes provide exceptional weatherability, durability, and long-term rooftop performance

	Mechanically Fastened	Induction Welded
	Flutes of Existing Metal Roof are filled with an Acceptable Insulation	
Flute Filler Attached By	Insulation is loose-laid into flutes Approved insulation is then laid over Flute Filler	
Insulation Attached By	Insulation is mechanically fastened into existing metal with InsulFast™ or HP-X Fasteners™	
Membrane Attached By	HP Purlin Fasteners and PIRANHA™ Plates are used to attach PVC or KEE HP membrane to existing purlins	HP Purlin Fasteners and Induction Welding Plates are used to attach PVC or KEE HP membrane to existing purlins

For more information, refer to Sure-Flex specifications. UL Class A Ratings available.
For current code approvals and warranties, visit Carlisle's website or contact a Carlisle Design Analyst.

Sure-Flex PVC/KEE HP

Mechanically Fastened Metal Retrofit



An Ideal Re-Roofing Solution

Convenience: Installs directly over existing metal roof eliminating costly and disruptive removal and replacement

Value: No adhesives provides ability to recycle membrane after its usable life

Performance: Highly reflective and chemically resistant roof system

Sure-Flex PVC and KEE HP Membranes

Carlisle's Sure-Flex PVC and KEE HP are high-performance, heat-weldable, single-ply membranes that provide outstanding long-term performance in new construction and re-roofing applications. Sure-Flex KEE HP membranes utilize the highest grade of DuPont™ Elvaloy® to ensure the membrane can withstand extreme climatic conditions.

Sure-Flex PVC Accessories

Carlisle also offers over a dozen prefabricated, in-stock accessories, and countless custom-order accessories. All carry a CFA (Certified Fabricated Accessory) stamp of approval, so you know they've been manufactured to the highest quality standards. Every Carlisle CFA saves you time and money during installation.



Installation

An acceptable insulation is used to fill the metal deck flutes. A subsequent layer of insulation or coverboard is then installed and secured to the metal roof with Carlisle InsulFast or HP-X Fasteners and insulation plates.

Metal Retrofit Mechanically Fastened Roofing System

PVC or KEE HP membrane is attached through the insulation (underlayment) to the purlins with Carlisle HP Purlin Fasteners and induction welding plates. Adjoining membrane sheets are hot-air welded together using an approved welder.

Membrane and System Strengths

- » Economical to install over existing metal roofs
- » Specially designed fastening system using induction welding plates anchors into the structural purlins (the strongest point of the roof) for optimum performance
- » Easily installed over most aged metal roofs
- » Heat-weldable seams provide a complete, monolithic membrane assembly
- » Sure-Flex PVC and KEE HP reinforced membranes are durable and puncture resistant

System Codes

- » UL Class A, B, and Unlimited Slope ratings are available
- » Meets FM Loss Prevention Data Sheet 1-31

For specific code approvals, refer to Carlisle's Code Approval Guide.

Inspection

Upon installation completion, and prior to the issuance of a membrane system warranty, an inspection will be conducted by a Carlisle Field Service Representative.

Warranty

Consult your Carlisle Authorized Applicator, Manufacturer's Representative, or Distributor for associated warranty charges.

This system, properly installed and inspected on a commercial project, may receive:

- » A 10-, 15-, or 20-year Total System Warranty when all materials used for the roofing installation are manufactured or marketed by Carlisle. A maximum peak gust wind speed coverage of 80 miles per hour is standard.
- » For more specifics or for international warranty programs, contact Carlisle.

