

## BlazeFrame® Flute Cover (FC)

### "FC" Fire Stop Flute Cover profiles

Corrugated strap for horizontal use to span fluted areas of unprotected or protected metal decks in up to 2 hr rated assemblies. Profile attached to deck "valley" surfaces a max 16" o.c. on both sides.

Profiles provide a surface area for attachment of head of wall partition track profiles centered or offset underneath and parallel to deck fluted areas per listed assemblies in UL Fire Resistance Directory.

- For connection details and fire rated assembly details on either of these systems, refer to [www.clarkdietrich.com/BlazeFrame](http://www.clarkdietrich.com/BlazeFrame).
- For Patents refer to [www.cd-patents.com](http://www.cd-patents.com)

### Product Data & Ordering Information:

<b>Material:</b>	Yield Strength: Grade 33ksi Coating: CP60 (CP90 available) 33mils: 20ga, 0.0346" Design Thickness, 0.0329" Min. Thickness
<b>Width (W):</b>	425 (4-1/4"), 675 (6-3/4") and 725 (7-1/4")
<b>Lengths:</b>	10'

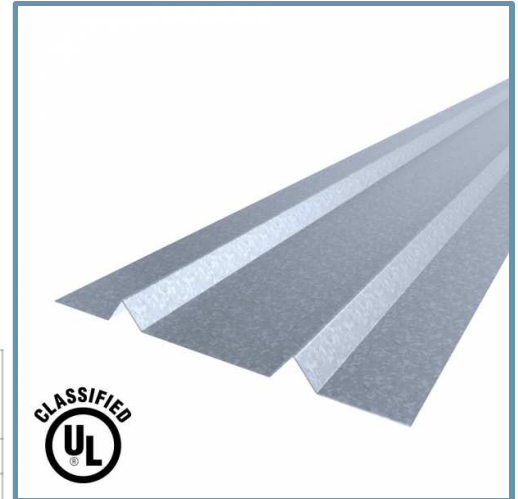

### Code Approvals & Performance Standards

- **AISI S220-20** North American Standard for Cold-Formed Steel Framing - Nonstructural Members
  - (Compliant to ASTM C645, but IBC replaced with AISI S220 in IBC 2015)
  - Section A3 Material - Chemical & mechanical requirements (Referencing ASTM A1003/A1003M)
  - Section A4 Corrosion Protection (Referencing ASTM A653/A653M)
  - Section C Installation - (Referencing ASTM C754)
- **UL Designs 2079 Fifth Edition** Tests for Fire Resistance of Building Joint Systems
  - (When used in conjunction with BlazeFrame Perimeter L-Bead)
  - IBC requires fire-resistant joint systems be tested in accordance w/the requirements of either ASTM E1966 or UL 2079.
- **UL File Number R26034-XHHW** Full list of BlazeFrame UL design assemblies
- **SDS For ASTM A1003 Steel Framing Products** For Interior Framing, Exterior Framing and Clips/Accessories

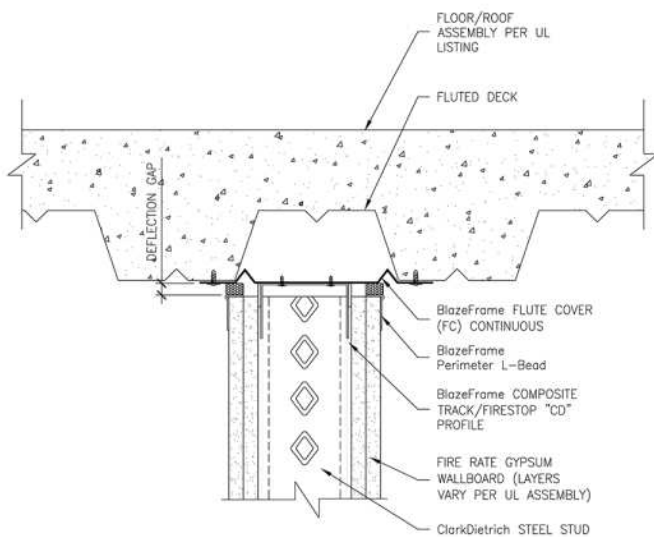

UL ASSEMBLY HW-D-0820

