

Mini-Bead™ 800 (MB80) and 900 (MB90)

Metal Corner Bead

Mini-Bead™ 800 and 900 are fine-mesh corner beads used to provide corner reinforcement for one-coat and two-coat veneer plaster systems. 1-1/4" wide fine-mesh flanges are tapered along the outer edges to enhance veneer plaster concealment. Mini-Bead™ 800 has 1/16" grounds for one-coat veneer plaster and 90 keys per linear foot for excellent bonding and strong corners. Mini-Bead™ 900 has 3/32" grounds for two-coat veneer plaster systems. Flange attachments can be accomplished by either nailing or stapling.

Product Data & Ordering Information

Material: 0.013 min thickness, G30 galvanized

Dimensions: 1-1/4" x 1-1/4"

Product Data & Ordering Information:

Product Code	Ground	Flanges	Length	Wt./Ctn.	Pcs./Ctn.
MB80	1/16"	1-1/4" x 1-1/4"	8'	34 lbs	60
MB80	1/16"	1-1/4" x 1-1/4"	10'	42 lbs	60
MB90	3/32"	1-1/4" x 1-1/4"	8'	34 lbs	60
MB90	3/32"	1-1/4" x 1-1/4"	10'	42 lbs	60

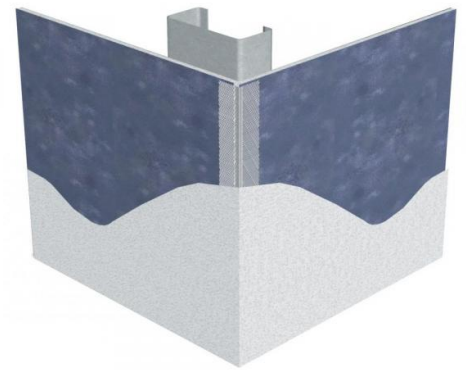
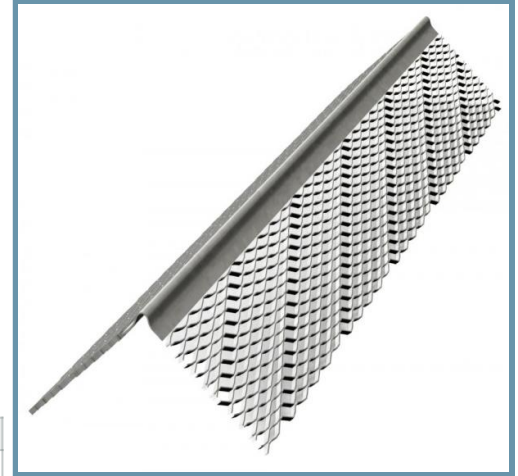

Code Approvals & Performance Standards

- [ASTM C841](#) Standard Specification for Installation of Interior Lathing and Furring
- [ASTM C1047](#) Standard Specification for Accessories for Gypsum Wallboard and Gypsum Veneer Base
- [ASTM C1063](#) Standard Specification for Installation of Lathing and Furring to Receive Interior and Exterior Portland Cement-Based Plaster
- [SDS For ASTM A653 Steel Finishing Products](#) For Interior Finishing and Exterior Finishing

Storage

All stored materials shall be kept dry. Materials shall be stacked off the ground, supported on a level platform, and protected from the weather.

Sustainability Credits For more details and LEED letters contact Technical Services at 888-437-3244 or visit clarkdietrich.com/LEED.

- **LEED v4.1 MR Credit:** Environmental Product Declarations: EPD (1 point) - Sourcing of Raw Materials (up to 2 points) - Material Ingredients (1 point) - Construction and Demolition Waste Management (up to 2 points)
- **LEED v4 MR Credit:** Building Product Disclosure and Optimization: EPD (1 point) - Sourcing of Raw Materials (1 point) - Material Ingredients (1 point) - Construction and Demolition Waste Management (up to 2 points) - Innovation Credit (up to 2 points).

- Mini-mesh flanges for plaster keying
- Galvanized
- Eliminates shadowing and edge cracking