

Chockfast® Epoxy Grout General Installation Steps

1. After the concrete has fully cured, chip the foundation using a light duty, hand held pneumatic chipping gun with a chisel ormoil type tool. The profile should be as aggressive as feasible and with at least 50% broken and exposed aggregate is visible.

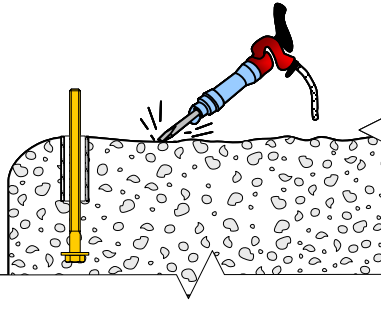

2. Anchor bolts should be prepared with at least 10 bolt diameters embedded for anchoring and at least 12 bolt diameters for free stretch. The free stretch length of the bolt must allow stretch of the bolt and prevent bonding of grout to the bolt.

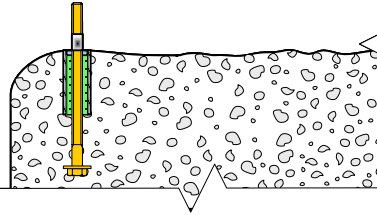

3. Expansion joints should be included in nearly all large pours of epoxy grout greater than 7 ft (2.1 m). This allows segmenting of the pour and dimensional changes due to temperature fluctuations. Nominal spacing of 4-7 ft (1.2 – 2.1 m) is recommended, and will depend on specifics of the application.

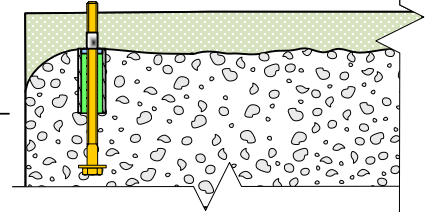

4. All bonding surfaces should be well cleaned and free of any dust, dirt, oil, water, or other residue. Any steel surfaces should be near white bare steel or coated with a high quality epoxy based primer.

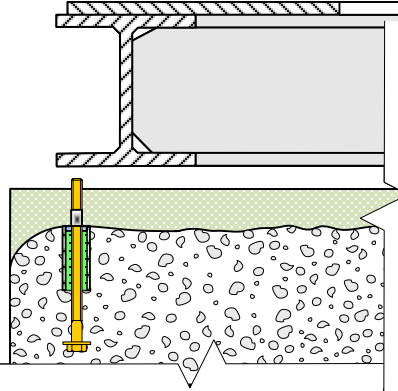

5. Install and align equipment on foundation using removable alignment devices, such as jacking screws. Screws should be well coated with a non-melt grease and land on a rounded leveling plate, anchored to the concrete with a structural adhesive, such as Phillybond #6.

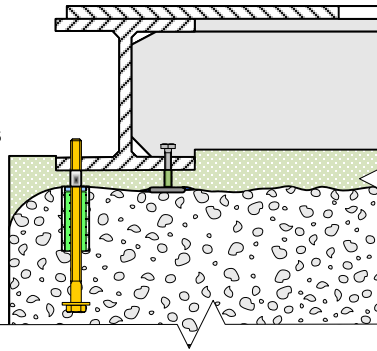

6. Nuts should be hand tight on anchor bolts to prevent floating of base. Construct leak-free formwork to place epoxy grout. Head boxes are recommended to provide hydraulic head pressure and aid installation. Coat forms with 3 coats of paste wax to prevent bonding.

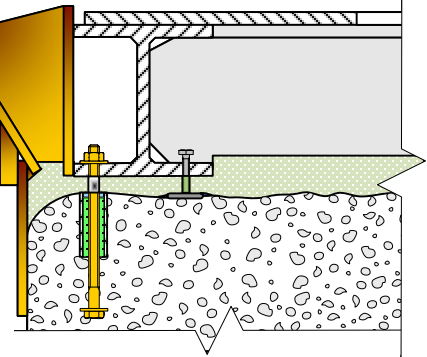

7. Pre-condition the Chockfast components, mixing equipment, and application area to 65°- 95°F (18°- 35°C).

All components should be at temperature **at least 24 hours before use** to ensure best mixing and installation.

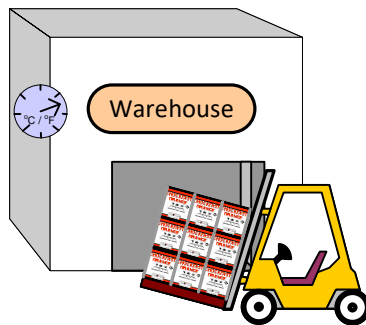

8. Mix epoxy grout liquids per Technical Data Sheet. Aggregate is added one bag at a time to the mortar mixer and only mixed until the aggregate is wet out. Place continuously from one direction until entire pour area is filled.

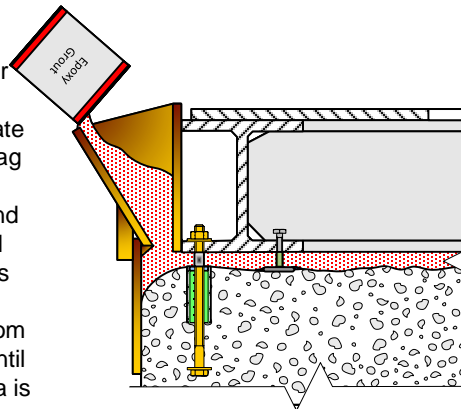

9. After recommended cure time, based on exposure temperature, has elapsed, remove formwork and alignment devices. Tension anchor bolts. Equipment start up may now commence.

