

KH-EZ 3/4"	h_1^*	h_{nom1} = 4.0"	h_{nom2} = 5.0"	h_{nom3} = 6.25"	h_{nom4} = 7.25"
		$t_{fix1 \text{ max}}$	$t_{fix2 \text{ max}}$	$t_{fix3 \text{ max}}$	$t_{fix4 \text{ max}}$
3/4" x 4 1/2"	4 7/8" - t_{fix}	1/2"	-	-	-
3/4" x 5 1/2"	5 7/8" - t_{fix}	1 1/2"	1/2"	-	-
3/4" x 7"	7 7/8" - t_{fix}	3"	2"	3/4"	-
3/4" x 8"	8 3/8" - t_{fix}	4"	3"	1 3/4"	3/4"
3/4" x 9"	9 3/8" - t_{fix}	5"	4"	2 3/4"	1 3/4"

2.2			
	Nuron SIW 4-22		
	Nuron SIW 6-22		
	Nuron SIW 8-22		
	SIW 22T/18T-A		
	SIW 9-A22		
		95 ft-lb	70 ft-lb

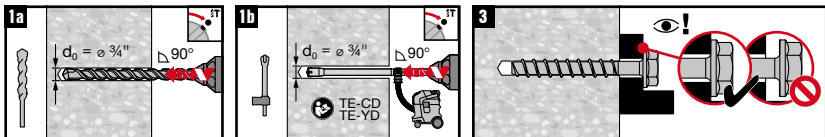

*For non-hole cleaning installation (step 1a), make sure to drill deep enough to achieve h_1 , taking into account the depth of debris remaining in the hole.