



BEAUTY ON THE OUTSIDE. FIRE RESISTANCE ON THE INSIDE.

For commercial and residential construction, LP® SmartSide® Trim & Siding can be incorporated with fire-resistance-rated wall assemblies when the building codes require protection from either side. LP SmartSide Trim & Siding is acceptable to add as cladding to approved fire-resistance-rated assemblies of which all specified components are working together to resist the spread of heat and flames and satisfy the life safety requirements of the code. Common fire-resistance-rated wall assemblies used with LP SmartSide Trim & Siding can include a combination of materials, including products like LP® FlameBlock® Fire-Rated Sheathing or Type X gypsum.

ASSEMBLY EXAMPLES

1-Hour Fire-Resistance-Rated Wall; Fire-Rated Either Side

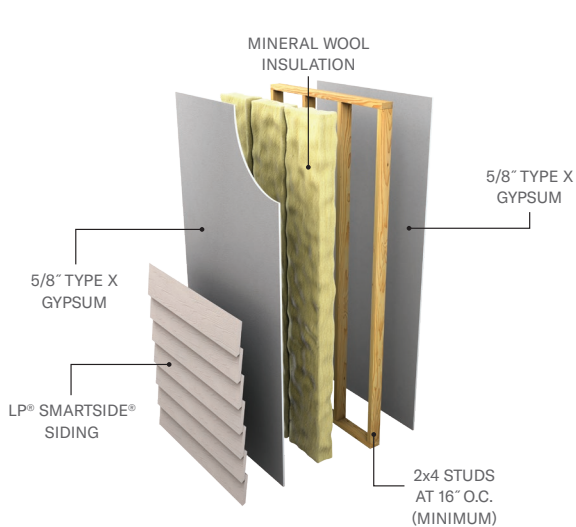

Exterior Load-Bearing Wall | UL Design No. U305

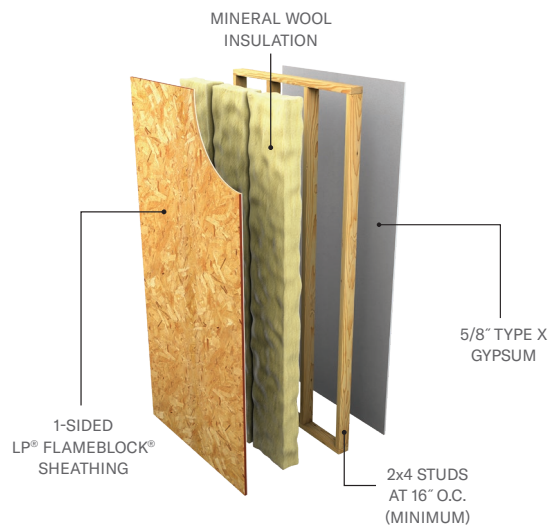

Exterior Load-Bearing Wall | UL Design No. V340



HOW CAN I USE LP® SMARTSIDE® TRIM & SIDING IN A FIRE-RESISTANCE-RATED WALL ASSEMBLY?

When selecting fire-resistance-rated wall assemblies, meeting the required rating specified by the code is most important. There are many assemblies with various combinations of materials to choose from. LP® SmartSide® Trim & Siding, one the most durable siding solutions available, makes a great exterior cladding that can be incorporated with LP® FlameBlock® Fire-Rated Sheathing or gypsum assemblies. This gives the beauty and durability clients want without sacrificing safety and performance.

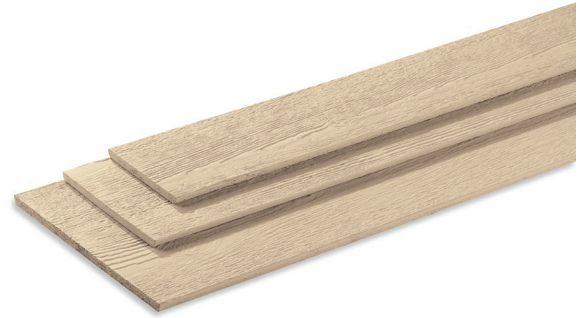

LP® SmartSide® Trim & Siding features treated engineered wood strand technology that offers protection against the elements.

HOW CAN I USE LP® FLAMEBLOCK® FIRE-RATED SHEATHING?

LP FlameBlock Fire-Rated Sheathing is evaluated to help meet code requirements for fire-resistant construction and is a component used in multiple 1-hour and 2-hour fire-resistance-rated wall assemblies. It can be used in single-family, townhouse and mid-rise construction as a listed component of fire-resistance-rated wall assemblies.

- Evaluated by ICC-ES (ESR-1365, ESL-1002, PMG-1089)
- UL and Intertek fire-resistance-rated wall assemblies tested in accordance with ASTM E119
- Equivalent load/span and shear design values to untreated wood structural panels of the same thickness



Look beneath the ignition-resistant Pyrotite® coating and you'll find the strength of LP OSB.

LP® FlameBlock® Fire-Rated Sheathing features a proprietary non-combustible, fiberglass-reinforced Pyrotite® treatment.



Find all product literature at LPCorp.com/literature

WARNING: Drilling, sawing, sanding or machining wood products can expose you to wood dust, a substance known to the State of California to cause cancer. Avoid inhaling wood dust or use a dust mask or other safeguards for personal protection. For more information, go to www.P65Warnings.ca.gov/wood.

© 2022 Louisiana-Pacific Corporation. All rights reserved. Sustainable Forestry Initiative, SFI and associated logo are registered trademarks of Sustainable Forestry Initiative, Inc. All other trademarks are owned by Louisiana-Pacific Corporation. LPZB0892 4/2022