

Marino\WARE® Product Submittal Data

MARINO\WARE PART # BH JOIST HANGER

MATERIAL: 12 ga (97 mil) 50ksi
FINISH: Galvanized – G90

OPTIONS:

Single BH Hanger:

- W=2-1/8" for 2" Flange Joist

Double BH Hanger:

- W=4-1/4" for 2" Flange Joists

Tripple BH Hanger:

- W=6-3/8" for all 2" Flange Joists

Model No.	W (in)	H (in)
800BH12		8
100BH12		10
120BH12	2-1/8"	12
140BH12		14
160BH12		16
800DB12		8
100DB12		10
120DB12	4-1/4"	12
140DB12		14
160DB12		16
800TBH12		8
100TBH12		10
120TBH12	6-3/8"	12
140TBH12		14
160TBH12		16

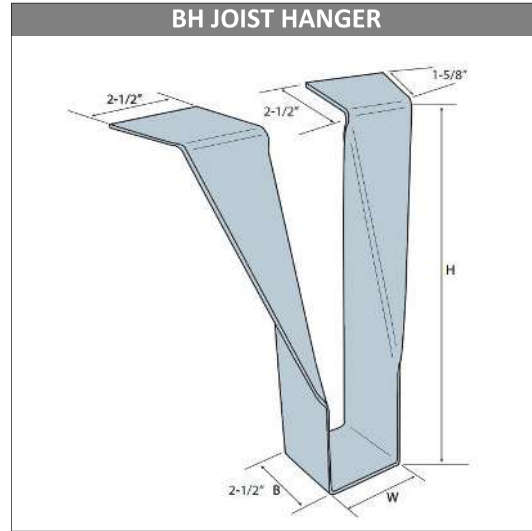

Notes:
 The height values (H) measured from the inside dimension from the seat of the hanger to the outside dimension at the top of the hanger.

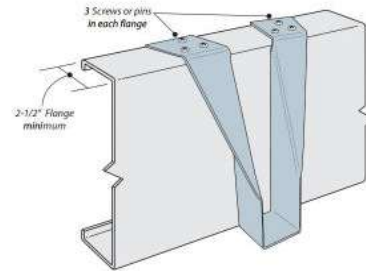
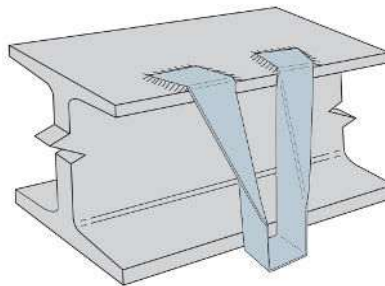

Model No.	Dimensions			Fastners	Allowable Downloads
	W (in)	H (in)	B (in)		
BH - Screw	See table	See table	2-1/2"	6-#10 Screws	2560
BH - Welded	See table	See table		1/8" x 2" Weld	4015
BH - P.A.F.	See table	See table		6-P.A.F. fasteners	2665

- Notes:**
1. Loads are governed by tests and may not be increased.
 2. The joist must be properly seated in the hanger.
 3. Header to be engineered by a design professional
 4. Powder actuated fastener and welded loads are based on hanger attached to 3/8" structural steel member.
 5. Loads for screw attached hanger were based on hanger attached to 68 mil CFS member.
 6. Powder actuated fastener loads were tested with Hilti X-U Pins.
 7. BH hangers were tested per AISI S914-08, Test Standard for Joist Connectors Attached to CFS framing.

CODES & STANDARDS

- Steel meets ASTM A1003
- Coating meets ASTM A1003, A653
- ICC ES ESR-3578

GREEN INFO

- LEED v4 credits available
- Contact Technical Services for more information



For more information, please contact Marino\WARE Technical Services at 866-545-1545.

This technical information reflects the most current information available and supersedes any and all publications, effective 10/1/2021.
 © Copyright 2021 by Ware Industries, Inc. All rights reserved