

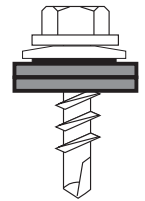

**HEX WASHER HEAD WITH NEOPRENE WASHER
SELF-DRILL SCREW - #10 BODY DIAMETER**



Steel to steel.

ES ESR 1408



HWH with 9/16" Neo. Washer

Product Specifications

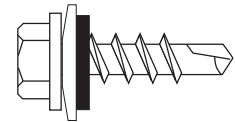

Part #	Dia.	Length	TPI	Bulk Qty	Finish	Corrosion	Head	Head Dia.	Thread	Drill Pt.	Drill Capacity
HDW1034	10	3/4	16	6M	Zinc	24 hr. min. B-117	5/16" A/F	9.76-10.5mm	FULL	3	.110"-.175"
HDW10100	10	1	16	5M	Zinc	24 hr. min. B-117	5/16" A/F	9.76-10.5mm	FULL	3	.110"-.175"
HDW10114	10	1-1/4	16	4M	Zinc	24 hr. min. B-117	5/16" A/F	9.76-10.5mm	FULL	3	.110"-.175"
HDW10112	10	1-1/2	16	3M	Zinc	24 hr. min. B-117	5/16" A/F	9.76-10.5mm	FULL	3	.110"-.175"
HDW10200	10	2	16	2M	Zinc	24 hr. min. B-117	5/16" A/F	9.76-10.5mm	FULL	3	.110"-.175"

Pro-Twist drill screws meet or exceed ASTM C-954 and/or C-1513

9/16" Neoprene Steel-Bonded Washer

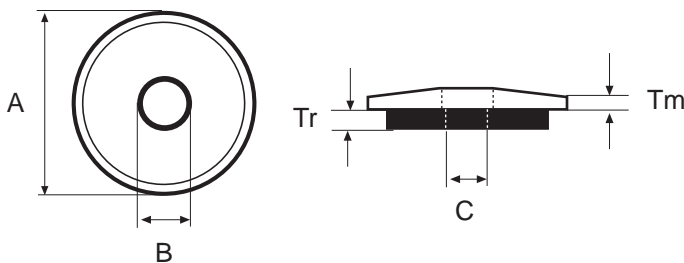

Dia.	Metal Gauge/1lb	Tension (Pull) Lbs. 1 Pc.	Shear Lbs. Metal to Metal	Torsional Strength
10	20	389	811	61 lbs.
	18	554	1223	
	16	727	1492	
	14	1050	1545	
	12	1216	1650	

Washer	A (O.D.) +/- 0.2	B (I.D.) +/- 0.25	C (EPDM I.D.) +/- 0.4	Tm +/- 0.1	Tr +/- 0.2
#10 - 9/16"	14.0	5.4	3.6	0.8	2.0

mm

Ultimate Value Charts

Screws driven into steel were driven with three exposed threads on the off side of the connection, then pulled out with testing machine.

Note that all results were obtained in strict adherence to ASTM test protocol. These ultimate figures are offered only as a guide and are not guaranteed in any way by PrimeSource Building Products. A 4:1 safety ratio is recommended.

Installation Guidelines

0-2500rpm Screwgun with torque adjustment - Overdriving may result in fastener failure or stripout of the work surface. The fastener is fully seated when the head's bearing surface is flush with the steel. The fastener must penetrate beyond the metal a minimum of three threads to comply with the code.

ALL PRIMESOURCE FASTENERS ARE MANUFACTURED IN AN ISO 9002 AND ISO 14001 CERTIFIED AND APPROVED FACTORY TO PRIMESOURCE PERFORMANCE SPECIFICATIONS AND PRINT DRAWINGS.