

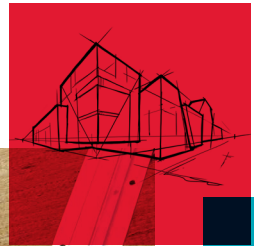

# ROCKWOOL Acoustic Wall Assemblies Catalog



This Acoustics Wall Assemblies Catalog provides a comprehensive list of wall assemblies tested for their acoustic performance. This includes both STC and OITC ratings for steel and wood stud walls, considering both interior and exterior assemblies.

**Using this guide:**

All assemblies include component descriptions, STC, OITC, and R-values (if available). In addition, each assembly references a ROCKWOOL test number, as well as the ROCKWOOL products included in the tested assembly.



**Insulation Included:**  
ROCKWOOL AFB

Acoustics		Assembly Number: ISS-00	
STC:	43	OITC:	28
Report No.	J2247-13-303-11-R0		
Assembly Components			
Finish material	5/8" Gypsum		
Size	2 1/2" Steel Stud		
Spacing	16" oc		
Product	AFB		
Thickness	1.5"		



**Have questions about rated assemblies?**

Contact ROCKWOOL Technical services for more information on a particular assembly including Transmission Loss Curve data and other documentation.

Talk to us at **1-877-823-9790**, or by email at **techservice@rockwool.com**

Interior Steel Stud Assemblies  
**STC Range**

**40-57**

Pages 10-22

Interior Wood Stud Assemblies  
**STC Range**

**36-66**

Pages 23-31

Exterior Wood Stud Assemblies  
**STC Range**

**35-39**

Pages 32

Exterior Steel Stud Assemblies  
**STC Range**

**43-52**

Pages 33-37



## AFB®

### Acoustical Fire Batt Insulation

ROCKWOOL AFB® is a stone wool batt insulation for interior partitions in commercial constructions where superior fire resistance and acoustical performance are required. AFB is specifically designed to reduce sound transmission and provides exceptional acoustic comfort when installed in a wall assembly with gypsum boards and resilient channels.

- Excellent noise reduction and sound absorption to help you create quieter, more productive environments.
- Non-combustible and fire resistant, stone wool works to contain a fire and prevent its spread.
- Is available in thicknesses ranging from 1"-6" in order to fit in a variety of stud sizes
- AFB evo is also available as a no added formaldehyde product offering in order to meet the specific design standards

Visit [rockwool.com/products/afb](http://rockwool.com/products/afb) for more information



## Safe'n'Sound®

### Residential Fire and Soundproofing Insulation

ROCKWOOL Safe'n'Sound® is a stone wool batt insulation for interior partitions of wood and steel frame residential construction where superior fire resistance and acoustical performance is required. Safe'n'Sound has excellent acoustical dampening properties and provides an easy friction fit into walls, ceiling and floor applications. It is GREENGUARD Gold Certified and contributes to a healthier indoor environment.

- Excellent noise reduction and sound absorption to help you create quieter, more productive environments.
- Non-combustible and fire resistant, stone wool works to contain a fire and prevent its spread.
- Is available in thicknesses for wall, floor/ceiling and I-Joist applications to meet every design need
- Lightweight and easy to install

Visit [rockwool.com/products/safensound](http://rockwool.com/products/safensound) for more information



## Comfortbatt®

### Thermal Batt Insulation

ROCKWOOL Comfortbatt® is a semi-rigid stone wool thermal batt insulation for exterior wood and steel stud applications. It features a unique flexible edge that allows for easy installation and helps prevent over compression to maintain its R-value.

- Excellent thermal performance providing a high R-value per inch
- Non-combustible and fire resistant, stone wool works to contain a fire and prevent its spread.
- Excellent noise reduction and sound absorption to help you create quieter, more productive environments.
- Water resistant, stone wool does not rot or promote the growth of mildew, fungi or mold
- Lightweight and easy to install

Visit [rockwool.com/products/comfortbatt](http://rockwool.com/products/comfortbatt) for more information



## ROXUL Safe® 45

### Residential Party Wall Insulation

ROXUL Safe® 45 is a semi-rigid stone wool insulation board that is specifically engineered as a fire-blocking material for concealed spaces of multi-unit residential buildings. Using ROXUL Safe® 45 with our ROCKWOOL batt insulation creates a high-density “party” wall system that improves sound dampening and fire performance.

- Reduces the time, labor and material costs usually associated with adding a double layer of gypsum over the wall studs.
- ROXUL Safe® 45 complies with the fire-blocking National Building Code
- Is easy to install, and offers excellent water and moisture resistance

Visit [rockwool.com/north-america/products/roxul-safe-45](http://rockwool.com/north-america/products/roxul-safe-45) for more information





## Comfortboard® 80

### Exterior Wall Insulation: Thermal Insulated Sheathing

ROCKWOOL Comfortboard® 80 is a rigid stone wool board designed for continuous insulation applications. A non-structural sheathing product, Comfortboard 80 provides increased thermal performance to the building envelope. Vapor permeable, Comfortboard 80 has the added benefit of allowing fast outward drying. The insulation also reduces thermal loss resulting in improved long-term thermal performance.

- Fire resistant stone wool can withstand temperatures of approximately 2,150°F (1177°C).
- Vapor permeable enabling wall systems to have superior drying potential, minimizing the risk of condensation and water accumulation.
- Reduces thermal bridging through wood framing, leading to a higher-performing building envelope.
- excellent noise reduction and sound absorption to help you create quieter, more productive environments.

Visit [rockwool.com/products/Comfortboard-80](https://rockwool.com/products/Comfortboard-80) for more information



## Cavityrock®

### Exterior Wall Insulation: Rainscreens and Cavity Walls

ROCKWOOL Cavityrock® is a semi-rigid stone wool insulation board designed for exterior cavity wall and rainscreen applications. Compatible with numerous cladding attachment systems, Cavityrock is non-combustible and available with a black mat finish.

- Non-combustible and fire resistant, stone wool works to contain a fire and prevent its spread.
- Water resistant and allows for effective drainage from an exterior wall assembly.
- Available black mat finish provides masking for improved open-joint cladding system aesthetics.
- Compatible with a variety of cladding systems including Z-girts, masonry ties, and fiberglass and stainless steel clips.
- Durable inorganic material that does not rot or promote the growth of mildew, fungi or bacteria
- Vapor permeable enabling wall systems to have superior drying potential, minimizing the risk of condensation and water accumulation.

Visit [rockwool.com/products/cavityrock](https://rockwool.com/products/cavityrock) for more information



## Interior Steel Stud Assemblies

This section will outline interior assemblies using steel studs in various thicknesses, spacings, finishes, and any additional components. Assemblies will be organized by STC value ranging from an STC of 40 to an STC of 57.

STC  
**40**

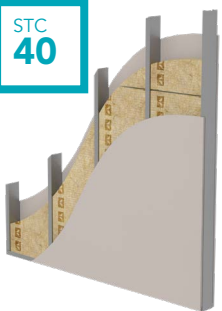

Acoustics		Assembly Number: ISS-01	
STC:	40	OITC:	27
Report No.	J2247-13-303-11-R0		
Assembly Components			
Finish material	1/2" Gypsum		
Size	3 5/8" Steel Stud		
Spacing	16" oc		
Product	AFB		
Thickness	3"		

**Insulation Included:**  
ROCKWOOL AFB

STC  
**43**



Acoustics		Assembly Number: ISS-02	
STC:	43	OITC:	28
Report No.	NWTL140828-03		
Assembly Components			
Finish material	5/8" Gypsum		
Size	3 5/8" Steel Stud		
Spacing	16" oc		
Product	AFB		
Thickness	3.5"		

**Insulation Included:**  
ROCKWOOL AFB

STC  
**43**



Acoustics		Assembly Number: ISS-03	
STC:	43	OITC:	28
Report No.	J2247-14-303-11-R0		
Assembly Components			
Finish material	5/8" Gypsum		
Size	2 1/2" Steel Stud		
Spacing	16" oc		
Product	AFB		
Thickness	1.5"		

**Insulation Included:**  
ROCKWOOL AFB

## Interior Steel Stud Assemblies

STC  
**43**

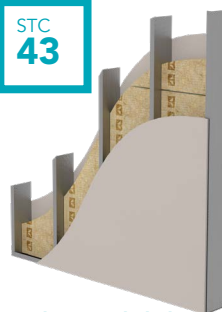

Acoustics		Assembly Number: ISS-04	
STC:	43	OITC:	27
Report No.	J2247-06-303-11-R0		
Assembly Components			
Finish material	1/2" Gypsum		
Size	6" Steel Stud		
Spacing	16" oc		
Product	AFB		
Thickness	3"		

**Insulation Included:**  
ROCKWOOL AFB

STC  
**44**

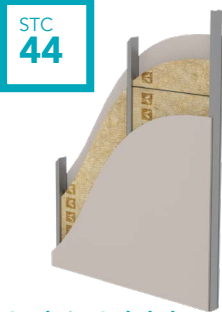

Acoustics		Assembly Number: ISS-05	
STC:	44	Report No.	RAL-TL90-197
Assembly Components			
Finish material	1/2" Gypsum		
Size	2 1/2" Steel Stud		
Spacing	24" oc		
Product	AFB		
Thickness	1"		

**Insulation Included:**  
ROCKWOOL AFB

STC  
**44**



Acoustics		Assembly Number: ISS-06	
STC:	44	Report No.	RAL-TL96-285
Assembly Components			
Finish material	1/2" gypsum		
Size	2 1/2" Steel Stud		
Spacing	24" oc		
Product	AFB		
Thickness	2.5"		

**Insulation Included:**  
ROCKWOOL AFB

Interior Steel Stud Assemblies

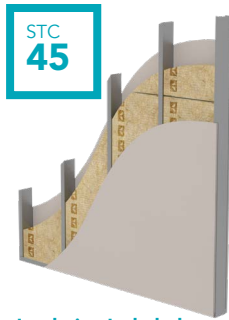

STC  
45

Acoustics Assembly Number: ISS-07

STC: 45 OITC: 29 Report No. J2247-11-303-11-R0

Assembly Components

Finish material	5/8" gypsum
Size	3 5/8" Steel Stud
Spacing	16" oc
Product	AFB
Thickness	3"

Insulation Included:  
ROCKWOOL AFB

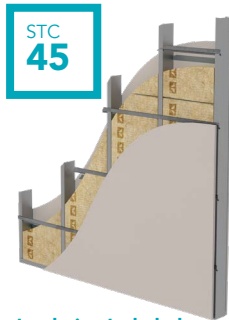

STC  
45

Acoustics Assembly Number: ISS-08

STC: 45 OITC: 29 Report No. NWTL140829-01

Assembly Components

Finish material	5/8" gypsum
Size	3 5/8" Steel Stud
Spacing	16" oc
Product	AFB
Thickness	3.5"
Resilient Channels	RC Deluxe, 16" OC

Insulation Included:  
ROCKWOOL AFB

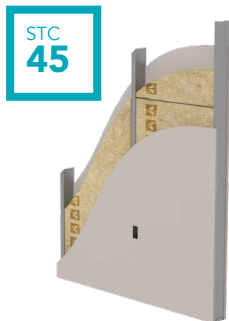

STC  
45

Acoustics Assembly Number: ISS-09

STC: 45 Report No. RAL-TL03-303

Assembly Components

Finish material	5/8" gypsum
Size	2 1/2" Steel Stud
Spacing	24" oc
Product	AFB
Thickness	1.5"
Penetrations	Electrical Boxes Included

Insulation Included:  
ROCKWOOL AFB

Interior Steel Stud Assemblies

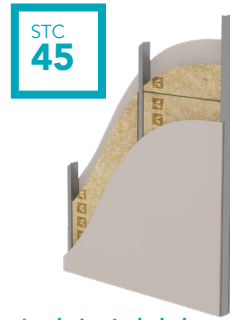

STC  
45

Acoustics Assembly Number: ISS-10

STC: 45 Report No. RAL-TL90-192

Assembly Components

Finish material	1/2" Gypsum
Size	2 1/2" Steel Stud
Spacing	24" oc
Product	AFB
Thickness	1.5"

Insulation Included:  
ROCKWOOL AFB

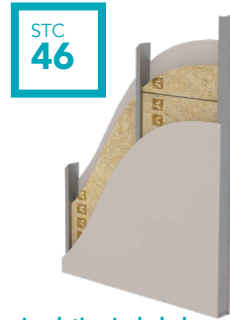

STC  
46

Acoustics Assembly Number: ISS-11

STC: 46 Report No. RAL-TL90-195

Assembly Components

Finish material	1/2" gypsum
Size	3 5/8" Steel Stud
Spacing	24" oc
Product	AFB
Thickness	1.5"

Insulation Included:  
ROCKWOOL AFB

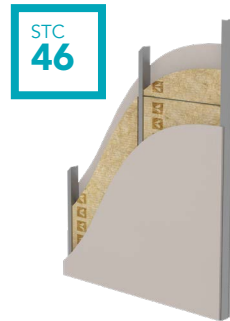

STC  
46

Acoustics Assembly Number: ISS-12

STC: 46 Report No. RAL-TL02-212

Assembly Components

Finish material	5/8" gypsum
Size	2 1/2" Steel Stud
Spacing	24" oc
Product	AFB
Thickness	1.5"

Insulation Included:  
ROCKWOOL AFB

Interior Steel Stud Assemblies

STC  
46



Acoustics		Assembly Number: ISS-13	
STC:	46	Report No.	RAL-TL96-270
Assembly Components			
Finish material	5/8" gypsum		
Size	2 1/2" Steel Stud		
Spacing	24" oc		
Product	AFB		
Thickness	2.5"		

Insulation Included:  
ROCKWOOL AFB

STC  
47

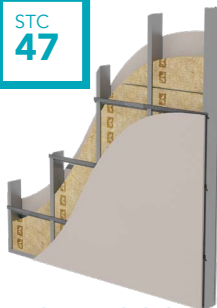

Acoustics		Assembly Number: ISS-14	
STC:	47	OITC:	29
Report No.	J2247-12-303-11-R0		
Assembly Components			
Finish material	1/2" gypsum		
Size	3 5/8" Steel Stud		
Spacing	16" oc		
Product	AFB		
Thickness	3"		
Resilient Channels	RC Deluxe, 16" OC		

Insulation Included:  
ROCKWOOL AFB

STC  
47

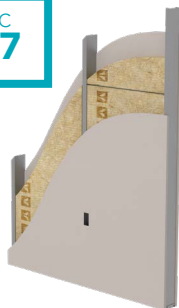

Acoustics		Assembly Number: ISS-15	
STC:	47	Report No.	RAL-TL03-306
Assembly Components			
Finish material	5/8" gypsum		
Size	3 5/8" Steel Stud		
Spacing	24" oc		
Product	AFB		
Thickness	3"		
Penetrations	Electrical Boxes Included		

Insulation Included:  
ROCKWOOL AFB

Interior Steel Stud Assemblies

STC  
47



Acoustics		Assembly Number: ISS-16	
STC:	47	OITC:	29
Report No.	J2247-05-303-11-R0		
Assembly Components			
Finish material	1/2" Gypsum		
Size	6" Steel Stud		
Spacing	16" oc		
Product	AFB		
Thickness	6"		

Insulation Included:  
ROCKWOOL AFB

STC  
49



Acoustics		Assembly Number: ISS-17	
STC:	49	OITC:	30
Report No.	NWTL140827-04		
Assembly Components			
Finish material	5/8" gypsum		
Size	3 5/8" Steel Stud		
Spacing	24" oc		
Product	AFB		
Thickness	3.5"		

Insulation Included:  
ROCKWOOL AFB

STC  
49



Acoustics		Assembly Number: ISS-18	
STC:	49	OITC:	32
Report No.	NWTL140828-02		
Assembly Components			
Finish material	5/8" gypsum		
Size	3 5/8" Steel Stud		
Spacing	24" oc		
Product	Comfortboard 80 (outboard, single side)		
Thickness	3"		

Insulation Included:  
ROCKWOOL Comfortboard 80  
(outboard, single side)



Interior Steel Stud Assemblies

STC  
50



Acoustics		Assembly Number: ISS-19	
STC:	50	OITC:	30
Report No.	F0256.01B		
Assembly Components			
Finish material	5/8" gypsum		
Size	3 5/8" Steel Stud		
Spacing	24" oc		
Product	AFB		
Thickness	3.5"		

Insulation Included:  
ROCKWOOL AFB

STC  
50



Acoustics		Assembly Number: ISS-20	
STC:	50	OITC:	31
Report No.	NWTL141118-04		
Assembly Components			
Finish material	5/8" gypsum		
Size	3 5/8" Steel Stud		
Spacing	24" oc		
Product	Minimum 4 pcf mineral wool board insulation (outboard, single side)		
Thickness	3"		

Insulation Included:  
ROCKWOOL 4 pcf mineral wool board insulation

STC  
50

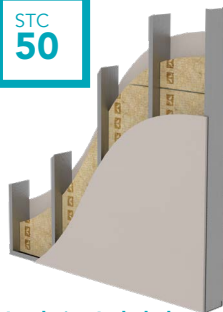

Acoustics		Assembly Number: ISS-21	
STC:	50	OITC:	34
Report No.	J2247-04-303-11-R0		
Assembly Components			
Finish material	5/8" gypsum		
Size	6" Steel Stud		
Spacing	16" oc		
Product	AFB		
Thickness	3"		

Insulation Included:  
ROCKWOOL AFB

Interior Steel Stud Assemblies

STC  
50



Acoustics		Assembly Number: ISS-22	
STC:	50	Report No.	RAL-TL90-186
Assembly Components			
Finish material	1/2" gypsum, 2x 1/2" gypsum on single side		
Size	2 1/2" Steel Stud		
Spacing	24" oc		
Product	AFB		
Thickness	1.5"		

Insulation Included:  
ROCKWOOL AFB

STC  
51



Acoustics		Assembly Number: ISS-23	
STC:	51	Report No.	RAL-TL96-269
Assembly Components			
Finish material	1/2" gypsum		
Size	3 5/8" Steel Stud		
Spacing	24" oc		
Product	AFB		
Thickness	3"		

Insulation Included:  
ROCKWOOL AFB

STC  
51



Acoustics		Assembly Number: ISS-24	
STC:	51	OITC:	31
Report No.	NWTL141119-01		
Assembly Components			
Finish material	5/8" gypsum		
Size	3 5/8" Steel Stud		
Spacing	24" oc		
Product	AFB		
Thickness	3"		

Insulation Included:  
ROCKWOOL AFB

Interior Steel Stud Assemblies



STC  
52

Acoustics Assembly Number: ISS-25

STC: 52 OITC: 35 Report No. J2247-03-303-11-R0

Assembly Components

Finish material	5/8" gypsum
Size	6" Steel Stud
Spacing	16" oc
Product	AFB
Thickness	6"

Insulation Included:  
ROCKWOOL AFB



STC  
53

Acoustics Assembly Number: ISS-26

STC: 53 Report No. RAL-TL96-288

Assembly Components

Finish material	1/2" gypsum
Size	3 5/8" Steel Stud
Spacing	24" oc
Product	AFB
Thickness	3"

Insulation Included:  
ROCKWOOL AFB

Resilient Channels  
Metal, 24" OC



STC  
53

Acoustics Assembly Number: ISS-27

STC: 53 OITC: 34 Report No. J2247.10-303-11-R0

Assembly Components

Finish material	5/8" gypsum
Size	3 5/8" Steel Stud
Spacing	16" oc
Product	AFB
Thickness	3"

Insulation Included:  
ROCKWOOL AFB

Resilient Channels  
RC Deluxe, 16" OC

Interior Steel Stud Assemblies



STC  
53

Acoustics Assembly Number: ISS-28

STC: 53 Report No. RAL-TL90-185

Assembly Components

Finish material	2x 1/2" gypsum
Size	2 1/2" Steel Stud
Spacing	24" oc
Product	AFB
Thickness	1.5"

Insulation Included:  
ROCKWOOL AFB



STC  
54

Acoustics Assembly Number: ISS-29

STC: 54 OITC: 37 Report No. J2247.08-303-11-R0

Assembly Components

Finish material	5/8" gypsum
Size	6" Steel Stud
Spacing	24" oc
Product	AFB
Thickness	3"

Insulation Included:  
ROCKWOOL AFB

Resilient Channels  
RC Deluxe, 16" OC



STC  
54

Acoustics Assembly Number: ISS-30

STC: 54 OITC: 35 Report No. J2247.02-303-11-R0

Assembly Components

Finish material	5/8" gypsum
Size	6" Steel Stud
Spacing	16" oc
Product	AFB
Thickness	3"

Insulation Included:  
ROCKWOOL AFB

Resilient Channels  
RC Deluxe, 16" OC

Interior Steel Stud Assemblies



STC  
55

Acoustics Assembly Number: ISS-31

STC: 55 Report No. RAL-TL96-289

Assembly Components

Finish material	5/8" gypsum
Size	3 5/8" Steel Stud
Spacing	24" oc
Product	AFB
Thickness	3"
Resilient Channels	Metal, 24" OC

Insulation Included:  
ROCKWOOL AFB



STC  
55

Acoustics Assembly Number: ISS-32

STC: 55 OITC: 35 Report No. NWTL140827-03

Assembly Components

Finish material	5/8" gypsum, 2x 5/8" gypsum on single side
Size	3 5/8" Steel Stud
Spacing	24" oc
Product	AFB
Thickness	3.5"

Insulation Included:  
ROCKWOOL AFB



STC  
55

Acoustics Assembly Number: ISS-33

STC: 55 Report No. RAL-TL02-296

Assembly Components

Finish material	5/8" gypsum
Size	6" Steel Stud
Spacing	24" oc
Product	AFB
Thickness	6"

Insulation Included:  
ROCKWOOL AFB

Interior Steel Stud Assemblies



STC  
56

Acoustics Assembly Number: ISS-34

STC: 56 Report No. RAL-TL96-264

Assembly Components

Finish material	5/8" gypsum, 2x 5/8" gypsum on single side
Size	3 5/8" Steel Stud
Spacing	24" oc
Product	AFB
Thickness	3.5"

Insulation Included:  
ROCKWOOL AFB



STC  
56

Acoustics Assembly Number: ISS-35

STC: 56 Report No. RAL-TL90-196

Assembly Components

Finish material	2x 1/2" gypsum
Size	3 5/8" Steel Stud
Spacing	24" oc
Product	AFB
Thickness	1.5"

Insulation Included:  
ROCKWOOL AFB



STC  
56

Acoustics Assembly Number: ISS-36

STC: 56 OITC: 39 Report No. J2247.07-303-11-R0

Assembly Components

Finish material	5/8" gypsum
Size	6" Steel Stud
Spacing	24" oc
Product	AFB
Thickness	6"

Insulation Included:  
ROCKWOOL AFB

Resilient Channels  
RC Deluxe, 16" OC

Interior Steel Stud Assemblies

**STC 56**

Acoustics		Assembly Number: ISS-37	
STC:	56	OITC:	39
Report No.	J2247.01-303-11-R0		
Assembly Components			
Finish material	5/8" gypsum		
Size	6" Steel Stud		
Spacing	16" oc		
Product	AFB		
Thickness	6"		
Resilient Channels	RC Deluxe, 16" OC		

**Insulation Included:**  
ROCKWOOL AFB

**STC 56**

Acoustics		Assembly Number: ISS-38	
STC:	56	Report No.	RAL-TL90-193
Assembly Components			
Finish material	2x 5/8" gypsum		
Size	2 1/2" Steel Stud		
Spacing	24" oc		
Product	AFB		
Thickness	1.5"		

**Insulation Included:**  
ROCKWOOL AFB

**STC 56**

Acoustics		Assembly Number: ISS-40	
STC:	56	OITC:	36
Report No.	RAL-TL23-194		
Assembly Components			
Finish material	5/8" gypsum, 2 x 5/8" gypsum on single side		
Size	6" Steel Stud		
Spacing	24" oc		
Product	AFB		
Thickness	3"		

**Insulation Included:**  
ROCKWOOL AFB

Interior Steel Stud Assemblies

**STC 57**

Acoustics		Assembly Number: ISS-39	
STC:	57	Report No.	RAL-TL96-268
Assembly Components			
Finish material	2x 5/8" gypsum		
Size	3 5/8" Steel Stud		
Spacing	24" oc		
Product	AFB		
Thickness	3"		

**Insulation Included:**  
ROCKWOOL AFB

**STC 57**

Acoustics		Assembly Number: ISS-41	
STC:	57	OITC:	38
Report No.	RAL-TL23-195		
Assembly Components			
Finish material	5/8" gypsum, 2x 5/8" gypsum on single side		
Size	6" Steel Stud		
Spacing	24" oc		
Product	AFB		
Thickness	6"		

**Insulation Included:**  
ROCKWOOL AFB

## Interior Wood Stud Assemblies

This section will outline interior assemblies using wood studs in various thicknesses, spacings, finishes, and any additional components. Assemblies will be organized by STC value ranging from an STC of 36 to an STC of 66.



**Insulation Included:**  
ROCKWOOL  
Safe'n'Sound/AFB

**Acoustics** Assembly Number: IWS-15

STC: 36 OITC: 27 Report No. TL21-355

**Assembly Components**

Finish material	5/8" type X gypsum
Size	2x6 Wood Stud
Spacing	16" oc
Product	Safe'n'Sound/AFB
Thickness	3"
Wall Configuration	Single Stud



**Insulation Included:**  
ROCKWOOL Comfortbatt

**Acoustics** Assembly Number: IWS-01

STC: 37 Report No. NGC 2011011

**Assembly Components**

Finish material	5/8" type X gypsum
Size	2 x 4 Wood Stud
Spacing	16" oc
Product	Comfortbatt
Thickness	3.5"
Wall Configuration	Single Stud



**Insulation Included:**  
ROCKWOOL  
Safe'n'Sound/AFB

**Acoustics** Assembly Number: IWS-16

STC: 38 OITC: 28 Report No. TL21-356

**Assembly Components**

Finish material	5/8" Type X gypsum
Size	2 x 6 Wood Stud
Spacing	16" oc
Product	Safe'n'Sound/AFB
Thickness	5.5"
Wall Configuration	Single Stud

## Interior Wood Stud Assemblies



**Insulation Included:**  
ROCKWOOL AFB

**Acoustics** Assembly Number: IWS-02

STC: 38 Report No. RAL-TL96-265

**Assembly Components**

Finish material	5/8" gypsum
Size	2 x 4 Wood Stud
Spacing	16" oc
Product	AFB
Thickness	3"
Wall Configuration	Single Stud



**Insulation Included:**  
ROCKWOOL AFB

**Acoustics** Assembly Number: IWS-03

STC: 38 Report No. RAL-TL96-266

**Assembly Components**

Finish material	1/2" gypsum
Size	2 x 4 Wood Stud
Spacing	16" oc
Product	AFB
Thickness	3"
Wall Configuration	Single Stud



**Insulation Included:**  
ROCKWOOL AFB

**Acoustics** Assembly Number: IWS-04

STC: 40 OITC: 32 Report No.

**Assembly Components**

Finish material	2 x 5/8" gypsum
Size	2 x 4 Wood Stud
Spacing	16" oc
Product	AFB
Thickness	3"
Wall Configuration	Single Stud



Interior Wood Stud Assemblies

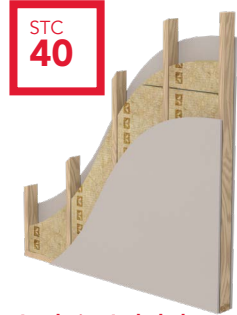

**Insulation Included:**  
ROCKWOOL Comfortbatt

Acoustics		Assembly Number: IWS-05	
STC:	40	Report No.	NGC 2011013
Assembly Components			
Finish material	1/2" gypsum		
Size	2 x 4 Wood Stud		
Spacing	16" oc		
Product	Comfortbatt		
Thickness	3.5"		
Wall Configuration	Single Stud		

Interior Wood Stud Assemblies



**Insulation Included:**  
ROCKWOOL  
Safe'n'Sound/AFB

Acoustics		Assembly Number: IWS-17	
STC:	48	OITC:	31
Report No.	TL21-358		
Assembly Components			
Finish material	2x 5/8" Type X gypsum		
Size	2 x 6 Wood Stud		
Spacing	24" oc		
Product	Safe'n'Sound/AFB		
Thickness	3"		
Wall Configuration	Single Stud		



**Insulation Included:**  
ROCKWOOL AFB

Acoustics		Assembly Number: IWS-06	
STC:	45	Report No.	RAL-TL02-300
Assembly Components			
Finish material	5/8" gypsum		
Size	2 x 6 Wood Stud		
Spacing	24" oc		
Product	AFB		
Thickness	5.5"		
Wall Configuration	Single Stud		



**Insulation Included:**  
ROCKWOOL  
Safe'n'Sound/AFB

Acoustics		Assembly Number: IWS-18	
STC:	48	OITC:	32
Report No.	TL21-359		
Assembly Components			
Finish material	2x 5/8" Type X gypsum		
Size	2 x 6 Wood Stud		
Spacing	24" oc		
Product	Safe'n'Sound/AFB		
Thickness	5.5"		
Wall Configuration	Single Stud		



**Insulation Included:**  
ROCKWOOL AFB

Acoustics		Assembly Number: IWS-07	
STC:	47	OITC:	33
Report No.	K2356.06-303-11-R0		
Assembly Components			
Finish material	5/8" gypsum		
Size	2 x 4 Wood Stud		
Spacing	16" oc		
Product	AFB		
Thickness	3"		
Resilient Channels	RC Deluxe, 16" oc, Single Stud		

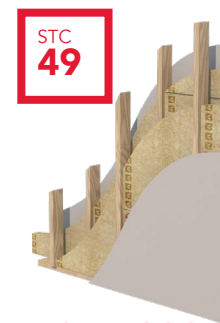

**Insulation Included:**  
ROCKWOOL Comfortbatt

Acoustics		Assembly Number: IWS-08	
STC:	49	Report No.	NGC 2011015
Assembly Components			
Finish material	1/2" gypsum		
Size	2 x 4 Wood Stud		
Spacing	24" oc		
Product	Comfortbatt		
Thickness	2.5" per row		
Wall Configuration	Staggered Studs		

Interior Wood Stud Assemblies

STC  
50



Acoustics		Assembly Number: IWS-19
STC:	50	OITC: 35 Report No. TL21-351
Assembly Components		
Finish material	5/8" Type X gypsum	
Size	2 x 4 Wood Stud	
Spacing	16" oc	
Product	Safe'n'Sound/AFB	
Thickness	3" per row, notched at opposing stud	
Wall Configuration	Staggered Studs	

Insulation Included:  
ROCKWOOL  
Safe'n'Sound/AFB

STC  
50

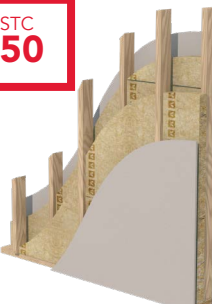

Acoustics		Assembly Number: IWS-09
STC:	50	Report No. NGC 2011014
Assembly Components		
Finish material	5/8" type X gypsum	
Size	2 x 4 Wood Stud	
Spacing	24" oc	
Product	Comfortbatt	
Thickness	2.5" per row	
Wall Configuration	Staggered Studs	

Insulation Included:  
ROCKWOOL Comfortbatt

STC  
51



Acoustics		Assembly Number: IWS-10
STC:	51	Report No. NGC 2011016
Assembly Components		
Finish material	5/8" type X gypsum	
Size	2 x 4 Wood Stud	
Spacing	24" oc	
Product	AFB	
Thickness	2" per row	
Wall Configuration	Staggered Studs	

Insulation Included:  
ROCKWOOL AFB

Interior Wood Stud Assemblies

STC  
52



Acoustics		Assembly Number: IWS-11
STC:	52	Report No. NGC 2010072
Assembly Components		
Finish material	1/2" gypsum	
Size	2 x 4 Wood Stud	
Spacing	16" oc	
Product	Comfortbatt	
Thickness	3.5" per row	
Wall Configuration	Double Stud with 1" Air Gap	

Insulation Included:  
ROCKWOOL Comfortbatt

STC  
53



Acoustics		Assembly Number: IWS-20
STC:	53	OITC: 37 Report No. TL21-357
Assembly Components		
Finish material	5/8" Type X gypsum	
Size	2 x 6 Wood Stud	
Spacing	16" oc	
Product	Safe'n'Sound/AFB	
Thickness	5.5"	
Wall Configuration	Single Stud	
Resilient Channels	24" oc	

Insulation Included:  
ROCKWOOL  
Safe'n'Sound/AFB

STC  
54



Acoustics		Assembly Number: IWS-21
STC:	54	OITC: 48 Report No. TL21-353
Assembly Components		
Finish material	2x 5/8" Type X gypsum	
Size	2 x 4 Wood Stud	
Spacing	24" oc	
Product	Safe'n'Sound/AFB	
Thickness	3" per row, notched at opposing stud	
Wall Configuration	Staggered Studs	

Insulation Included:  
ROCKWOOL  
Safe'n'Sound/AFB

Interior Wood Stud Assemblies



STC  
56

**Insulation Included:**  
ROCKWOOL Safe'n'Sound

Acoustics		Assembly Number: IWS-12	
STC:	56	Report No.	NGC 2010071
Assembly Components			
Finish material	5/8" type X gypsum		
Size	2 x 4 Wood Stud		
Spacing	16" oc		
Product	Safe'n'Sound		
Thickness	3" per row		
Wall Configuration	Double Stud with 1" Air Gap		

Interior Wood Stud Assemblies



STC  
60

**Insulation Included:**  
ROCKWOOL Comfortbatt

Acoustics		Assembly Number: IWS-14	
STC:	60	Report No.	NGC 2010069
Assembly Components			
Finish material	5/8" type X gypsum		
Size	2 x 4 Wood Stud		
Spacing	16" oc		
Product	Comfortbatt		
Thickness	3.5" per row		
Wall Configuration	Double Stud with 1" Air Gap		



STC  
57

**Insulation Included:**  
ROCKWOOL  
Safe'n'Sound/AFB

Acoustics		Assembly Number: IWS-22	
STC:	57	OITC:	38
Report No.	TL21-352		
Assembly Components			
Finish material	5/8" Type X gypsum		
Size	2 x 4 Wood Stud		
Spacing	16" oc		
Product	Safe'n'Sound/AFB		
Thickness	3" per row, notched at opposing stud		
Wall Configuration	Staggered Studs		
Resilient Channels	24" oc		



STC  
61

**Insulation Included:**  
ROCKWOOL  
Safe'n'Sound/AFB

Acoustics		Assembly Number: IWS-23	
STC:	61	OITC:	46
Report No.	TL21-360		
Assembly Components			
Finish material	2x 5/8" Type X gypsum		
Size	2 x 6 Wood Stud		
Spacing	24" oc		
Product	Safe'n'Sound/AFB		
Thickness	5.5"		
Wall Configuration	Single Stud		
Resilient Channels	24" oc		



STC  
58

**Insulation Included:**  
ROCKWOOL Comfortbatt  
ROXUL Safe 45

Acoustics		Assembly Number: IWS-13	
STC:	58	OITC:	33
Report No.	NGC 2010070		
Assembly Components			
Finish material	5/8" type X gypsum		
Size	2 x 4 Wood Stud		
Spacing	16" oc		
Product	Comfortbatt		
Thickness	3.5" per row		
Wall Configuration	Double Stud with 1" ROXUL Safe 45		



STC  
66

**Insulation Included:**  
ROCKWOOL  
Safe'n'Sound/AFB

Acoustics		Assembly Number: IWS-24	
STC:	66	OITC:	50
Report No.	TL21-349		
Assembly Components			
Finish material	2x 5/8" Type X gypsum		
Size	2 x 4 Wood Stud		
Spacing	16" oc		
Product	Safe'n'Sound/AFB		
Thickness	3" per row		
Wall Configuration	Double Stud with 1" Air Gap		

## Interior Wood Stud Assemblies



**Insulation Included:**  
ROCKWOOL  
Safe'n'Sound/AFB

**Acoustics** Assembly Number: IWS-25

STC: 66 OITC: 52 Report No. TL21-350

**Assembly Components**

Finish material 2x 5/8" Type X gypsum

Size 2 x 4 Wood Stud

Spacing 24" oc

Product Safe'n'Sound/AFB

Thickness 3" per row

Wall Configuration Double Stud with 1" Air Gap



**Insulation Included:**  
ROCKWOOL  
Safe'n'Sound/AFB

**Acoustics** Assembly Number: IWS-26

STC: 66 OITC: 51 Report No. TL21-354

**Assembly Components**

Finish material 2x 5/8" Type X gypsum

Size 2 x 4 Wood Stud

Spacing 24" oc

Product Safe'n'Sound/AFB

Thickness 3" per row, notched at opposing stud

Wall Configuration Staggered Studs, on 2x6 plates

Resilient Channels 16" oc

**Looking for building science support?**  
ROCKWOOL is here to help with a full range of building modeling to help with your project.

Visit: [rockwool.com/buildingscience](https://rockwool.com/buildingscience) for more information



## Exterior Wood Stud Assemblies

This section will outline exterior assemblies using wood studs in various thicknesses, spacings, finishes, and any additional components. Assemblies will be organized by STC value ranging from an STC of 35 to an STC of 39.



**Insulation Included:**  
ROCKWOOL Comfortbatt

**Acoustics** Assembly Number: EWS-01

STC: 35 OITC: 27 Report No. H5383.01-113-11-R0

**Assembly Components**

Finish material 5/8" gypsum

Size 2 x 6 Wood Stud

Spacing 16" oc

Product Comfortbatt

Thickness 6"

Sheathing 1/2 plywood with Air Barrier

Continuous Insulation .

Insulation Thickness .

Insulation Fastening .



**Insulation Included:**  
ROCKWOOL Comfortbatt  
ROCKWOOL Comfortboard 80

**Acoustics** Assembly Number: EWS-02

STC: 39 OITC: 29 Report No. H5383.02-113-11-R0

**Assembly Components**

Finish material 5/8" gypsum

Size 2 x 6 Wood Stud

Spacing 16" oc

Product Comfortbatt

Thickness 6"

Sheathing 1/2 plywood with Air Barrier

Continuous Insulation Comfortboard 80

Insulation Thickness 1.5

Insulation Fastening Furring Strips

## Exterior Steel Stud Assemblies

This section will outline exterior assemblies using steel studs in various thicknesses, spacings, finishes, and any additional components. Assemblies will be organized by STC value ranging from an STC of 43 to an STC of 52.



**Insulation Included:**  
ROCKWOOL  
Comfortboard 110

Acoustics		Assembly Number: ESS-01	
STC:	43	OITC:	30
Report No.	H5383.06-113-11-R0		
Assembly Components			
Finish material	1/2" gypsum		
Size	6" Steel Stud		
Spacing	16" oc		
Batt Product	.		
Thickness	.		
Sheathing	5/8" gypsum with Air Barrier		
Continuous Insulation	Comfortboard 110		
Insulation Thickness	1"		
Insulation Fastening	Furring Strips		
Cladding	None		



**Insulation Included:**  
ROCKWOOL Cavityrock

Acoustics		Assembly Number: ESS-02	
STC:	44	OITC:	29
Report No.	96973.01-113-11		
Assembly Components			
Finish material	1/2" gypsum		
Size	6" Steel Stud		
Spacing	16" oc		
Batt Product	.		
Thickness	.		
Sheathing	5/8" gypsum with Air Barrier		
Continuous Insulation	Cavityrock		
Insulation Thickness	3"		
Insulation Fastening	Z-girts		
Cladding	5/16" Cement Board		

## Exterior Steel Stud Assemblies



**Insulation Included:**  
ROCKWOOL Comfortbatt  
Polyiso Insulation

Acoustics		Assembly Number: ESS-03	
STC:	47	OITC:	30
Report No.	96641.01-113-11		
Assembly Components			
Finish material	1/2" gypsum		
Size	6" Steel Stud		
Spacing	16" oc		
Batt Product	Comfortbatt		
Thickness	6"		
Sheathing	5/8" gypsum with Air Barrier		
Continuous Insulation	Polyiso		
Insulation Thickness	3"		
Insulation Fastening	Z-girts		
Cladding	5/16" Cement Board		



**Insulation Included:**  
ROCKWOOL Comfortbatt

Acoustics		Assembly Number: ESS-04	
STC:	48	OITC:	30
Report No.	96642.01-113-11		
Assembly Components			
Finish material	1/2" gypsum		
Size	6" Steel Stud		
Spacing	16" oc		
Batt Product	Comfortbatt		
Thickness	6"		
Sheathing	5/8" gypsum with Air Barrier		
Continuous Insulation	Air Gap		
Insulation Thickness	.		
Insulation Fastening	Z-girts		
Cladding	5/16" Cement Board		



Exterior Steel Stud Assemblies



STC  
49

Acoustics		Assembly Number: ESS-05	
STC:	49	OITC:	32
Report No.	H5383.03-113-11-R0		
Assembly Components			
Finish material	5/8" gypsum		
Size	3 5/8" Steel Stud		
Spacing	16" oc		
Batt Product	Comfortbatt		
Thickness	3.5"		
Sheathing	5/8" gypsum with Air Barrier		
Continuous Insulation	Cavityrock		
Insulation Thickness	2"		
Insulation Fastening	Z-girts		
Cladding	None		

**Insulation Included:**  
ROCKWOOL Comfortbatt  
ROCKWOOL Cavityrock



STC  
49

Acoustics		Assembly Number: ESS-06	
STC:	49	OITC:	32
Report No.	97175.01-113-11		
Assembly Components			
Finish material	5/8" gypsum		
Size	6" Steel Stud		
Spacing	16" oc		
Batt Product	Comfortbatt		
Thickness	6"		
Sheathing	5/8" gypsum with Air Barrier		
Continuous Insulation	Cavityrock		
Insulation Thickness	3"		
Insulation Fastening	Z-girts		
Cladding	5/16" Cement Board		

**Insulation Included:**  
ROCKWOOL Comfortbatt  
ROCKWOOL Cavityrock

Exterior Steel Stud Assemblies



STC  
50

Acoustics		Assembly Number: ESS-07	
STC:	50	OITC:	31
Report No.	96644.01-113-11		
Assembly Components			
Finish material	1/2" gypsum		
Size	6" Steel Stud		
Spacing	16" oc		
Batt Product	Comfortbatt		
Thickness	6"		
Sheathing	5/8" gypsum with Air Barrier		
Continuous Insulation	Cavityrock		
Insulation Thickness	3"		
Insulation Fastening	Z-girts		
Cladding	5/16" Cement Board		

**Insulation Included:**  
ROCKWOOL Comfortbatt  
ROCKWOOL Cavityrock

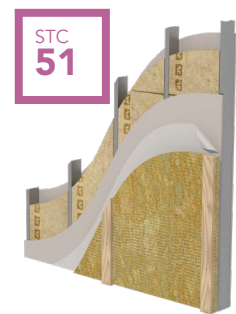

STC  
51

Acoustics		Assembly Number: ESS-08	
STC:	51	OITC:	32
Report No.	H5383.05-113-11-R0		
Assembly Components			
Finish material	5/8" gypsum		
Size	3 5/8" Steel Stud		
Spacing	16" oc		
Batt Product	Comfortbatt		
Thickness	3.5"		
Sheathing	1/2" gypsum with Air Barrier		
Continuous Insulation	Comfortboard 110		
Insulation Thickness	1"		
Insulation Fastening	Furring Strips		
Cladding	None		

**Insulation Included:**  
ROCKWOOL Comfortbatt  
ROCKWOOL Comfortboard 110



At the ROCKWOOL Group, we are committed to enriching the lives of everyone who comes into contact with our solutions. Our expertise is perfectly suited to tackle many of today's biggest sustainability and development challenges, from energy consumption and noise pollution to fire resilience, water scarcity and flooding. Our range of products reflects the diversity of the world's needs, while supporting our stakeholders in reducing their own carbon footprint.

Stone wool is a versatile material and forms the basis of all our businesses. With more than 11,000 employees in 39 countries, we are the world leader in stone wool solutions, from building insulation to acoustic ceilings, external cladding systems to horticultural solutions, engineered fibres for industrial use to insulation for the process industry and marine and offshore.

AFB®, Cavityrock®, Comfortbatt®, Comfortboard®, Conrock®, Curtainrock®, ROXUL Safe®, Rockboard®, Toprock®, Monoboard®, ROXUL® are registered trademarks of the ROCKWOOL Group in USA and ROXUL Inc. in Canada.

ROCKWOOL™, Fabrock™ are trademarks of the ROCKWOOL Group in USA and ROXUL Inc. in Canada.

SAFE'n'SOUND® is a registered trademark used under license by Masonite Inc.

06-2023



**ROCKWOOL**  
8024 Esquesing Line  
Milton, ON L9T 6W3  
Tel: 1 800 265 6878  
rockwool.com