

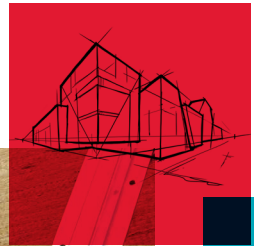

ROCKWOOL Acoustic Wall Assemblies Catalog



This Acoustics Wall Assemblies Catalog provides a comprehensive list of wall assemblies tested for their acoustic performance. This includes both STC and OITC ratings for steel and wood stud walls, considering both interior and exterior assemblies.

Using this guide:

All assemblies include component descriptions, STC, OITC, and R-values (if available). In addition, each assembly references a ROCKWOOL test number, as well as the ROCKWOOL products included in the tested assembly.



Insulation Included:
ROCKWOOL AFB

| | | | |
|---------------------|--------------------|-------------------------|----|
| Acoustics | | Assembly Number: ISS-00 | |
| STC: | 43 | OITC: | 28 |
| Report No. | J2247-13-303-11-R0 | | |
| Assembly Components | | | |
| Finish material | 5/8" Gypsum | | |
| Size | 2 1/2" Steel Stud | | |
| Spacing | 16" oc | | |
| Product | AFB | | |
| Thickness | 1.5" | | |



Have questions about rated assemblies?

Contact ROCKWOOL Technical services for more information on a particular assembly including Transmission Loss Curve data and other documentation.

Talk to us at **1-877-823-9790**, or by email at **techservice@rockwool.com**

Interior Steel Stud Assemblies
STC Range

40-57

Pages 10-22

Interior Wood Stud Assemblies
STC Range

36-66

Pages 23-31

Exterior Wood Stud Assemblies
STC Range

35-39

Pages 32

Exterior Steel Stud Assemblies
STC Range

43-52

Pages 33-37



AFB®

Acoustical Fire Batt Insulation

ROCKWOOL AFB® is a stone wool batt insulation for interior partitions in commercial constructions where superior fire resistance and acoustical performance are required. AFB is specifically designed to reduce sound transmission and provides exceptional acoustic comfort when installed in a wall assembly with gypsum boards and resilient channels.

- Excellent noise reduction and sound absorption to help you create quieter, more productive environments.
- Non-combustible and fire resistant, stone wool works to contain a fire and prevent its spread.
- Is available in thicknesses ranging from 1"-6" in order to fit in a variety of stud sizes
- AFB evo is also available as a no added formaldehyde product offering in order to meet the specific design standards

Visit rockwool.com/products/afb for more information



Safe'n'Sound®

Residential Fire and Soundproofing Insulation

ROCKWOOL Safe'n'Sound® is a stone wool batt insulation for interior partitions of wood and steel frame residential construction where superior fire resistance and acoustical performance is required. Safe'n'Sound has excellent acoustical dampening properties and provides an easy friction fit into walls, ceiling and floor applications. It is GREENGUARD Gold Certified and contributes to a healthier indoor environment.

- Excellent noise reduction and sound absorption to help you create quieter, more productive environments.
- Non-combustible and fire resistant, stone wool works to contain a fire and prevent its spread.
- Is available in thicknesses for wall, floor/ceiling and I-Joist applications to meet every design need
- Lightweight and easy to install

Visit rockwool.com/products/safensound for more information



Comfortbatt®

Thermal Batt Insulation

ROCKWOOL Comfortbatt® is a semi-rigid stone wool thermal batt insulation for exterior wood and steel stud applications. It features a unique flexible edge that allows for easy installation and helps prevent over compression to maintain its R-value.

- Excellent thermal performance providing a high R-value per inch
- Non-combustible and fire resistant, stone wool works to contain a fire and prevent its spread.
- Excellent noise reduction and sound absorption to help you create quieter, more productive environments.
- Water resistant, stone wool does not rot or promote the growth of mildew, fungi or mold
- Lightweight and easy to install

Visit rockwool.com/products/comfortbatt for more information



ROXUL Safe® 45

Residential Party Wall Insulation

ROXUL Safe® 45 is a semi-rigid stone wool insulation board that is specifically engineered as a fire-blocking material for concealed spaces of multi-unit residential buildings. Using ROXUL Safe® 45 with our ROCKWOOL batt insulation creates a high-density “party” wall system that improves sound dampening and fire performance.

- Reduces the time, labor and material costs usually associated with adding a double layer of gypsum over the wall studs.
- ROXUL Safe® 45 complies with the fire-blocking National Building Code
- Is easy to install, and offers excellent water and moisture resistance

Visit rockwool.com/north-america/products/roxul-safe-45 for more information



Comfortboard® 80

Exterior Wall Insulation: Thermal Insulated Sheathing

ROCKWOOL Comfortboard® 80 is a rigid stone wool board designed for continuous insulation applications. A non-structural sheathing product, Comfortboard 80 provides increased thermal performance to the building envelope. Vapor permeable, Comfortboard 80 has the added benefit of allowing fast outward drying. The insulation also reduces thermal loss resulting in improved long-term thermal performance.

- Fire resistant stone wool can withstand temperatures of approximately 2,150°F (1177°C).
- Vapor permeable enabling wall systems to have superior drying potential, minimizing the risk of condensation and water accumulation.
- Reduces thermal bridging through wood framing, leading to a higher-performing building envelope.
- excellent noise reduction and sound absorption to help you create quieter, more productive environments.

Visit rockwool.com/products/Comfortboard-80 for more information



Cavityrock®

Exterior Wall Insulation: Rainscreens and Cavity Walls

ROCKWOOL Cavityrock® is a semi-rigid stone wool insulation board designed for exterior cavity wall and rainscreen applications. Compatible with numerous cladding attachment systems, Cavityrock is non-combustible and available with a black mat finish.

- Non-combustible and fire resistant, stone wool works to contain a fire and prevent its spread.
- Water resistant and allows for effective drainage from an exterior wall assembly.
- Available black mat finish provides masking for improved open-joint cladding system aesthetics.
- Compatible with a variety of cladding systems including Z-girts, masonry ties, and fiberglass and stainless steel clips.
- Durable inorganic material that does not rot or promote the growth of mildew, fungi or bacteria
- Vapor permeable enabling wall systems to have superior drying potential, minimizing the risk of condensation and water accumulation.

Visit rockwool.com/products/cavityrock for more information



Interior Steel Stud Assemblies

This section will outline interior assemblies using steel studs in various thicknesses, spacings, finishes, and any additional components. Assemblies will be organized by STC value ranging from an STC of 40 to an STC of 57.

STC
40

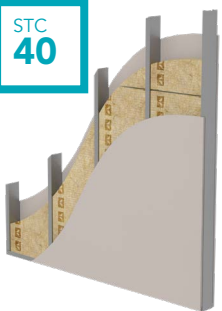

| Acoustics | | Assembly Number: ISS-01 | |
|---------------------|--------------------|-------------------------|----|
| STC: | 40 | OITC: | 27 |
| Report No. | J2247-13-303-11-R0 | | |
| Assembly Components | | | |
| Finish material | 1/2" Gypsum | | |
| Size | 3 5/8" Steel Stud | | |
| Spacing | 16" oc | | |
| Product | AFB | | |
| Thickness | 3" | | |

Insulation Included:
ROCKWOOL AFB

STC
43

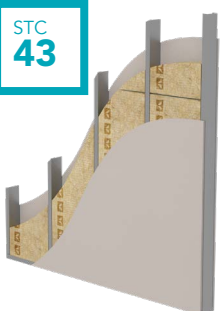

| Acoustics | | Assembly Number: ISS-02 | |
|---------------------|-------------------|-------------------------|----|
| STC: | 43 | OITC: | 28 |
| Report No. | NWT140828-03 | | |
| Assembly Components | | | |
| Finish material | 5/8" Gypsum | | |
| Size | 3 5/8" Steel Stud | | |
| Spacing | 16" oc | | |
| Product | AFB | | |
| Thickness | 3.5" | | |

Insulation Included:
ROCKWOOL AFB

STC
43

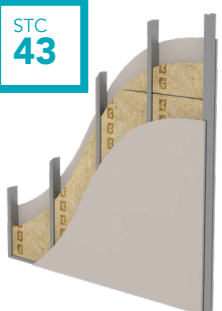

| Acoustics | | Assembly Number: ISS-03 | |
|---------------------|--------------------|-------------------------|----|
| STC: | 43 | OITC: | 28 |
| Report No. | J2247-14-303-11-R0 | | |
| Assembly Components | | | |
| Finish material | 5/8" Gypsum | | |
| Size | 2 1/2" Steel Stud | | |
| Spacing | 16" oc | | |
| Product | AFB | | |
| Thickness | 1.5" | | |

Insulation Included:
ROCKWOOL AFB

Interior Steel Stud Assemblies

STC
43

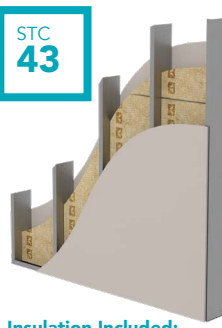

| Acoustics | | Assembly Number: ISS-04 | |
|---------------------|--------------------|-------------------------|----|
| STC: | 43 | OITC: | 27 |
| Report No. | J2247-06-303-11-R0 | | |
| Assembly Components | | | |
| Finish material | 1/2" Gypsum | | |
| Size | 6" Steel Stud | | |
| Spacing | 16" oc | | |
| Product | AFB | | |
| Thickness | 3" | | |

Insulation Included:
ROCKWOOL AFB

STC
44

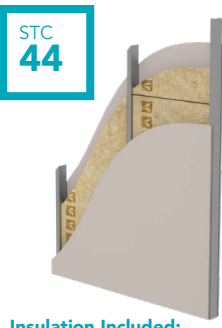

| Acoustics | | Assembly Number: ISS-05 | |
|---------------------|-------------------|-------------------------|--------------|
| STC: | 44 | Report No. | RAL-TL90-197 |
| Assembly Components | | | |
| Finish material | 1/2" Gypsum | | |
| Size | 2 1/2" Steel Stud | | |
| Spacing | 24" oc | | |
| Product | AFB | | |
| Thickness | 1" | | |

Insulation Included:
ROCKWOOL AFB

STC
44



| Acoustics | | Assembly Number: ISS-06 | |
|---------------------|-------------------|-------------------------|--------------|
| STC: | 44 | Report No. | RAL-TL96-285 |
| Assembly Components | | | |
| Finish material | 1/2" gypsum | | |
| Size | 2 1/2" Steel Stud | | |
| Spacing | 24" oc | | |
| Product | AFB | | |
| Thickness | 2.5" | | |

Insulation Included:
ROCKWOOL AFB

Interior Steel Stud Assemblies



STC
45

| Acoustics | | Assembly Number: ISS-07 | |
|---------------------|--------------------|-------------------------|----|
| STC: | 45 | OITC: | 29 |
| Report No. | J2247-11-303-11-R0 | | |
| Assembly Components | | | |
| Finish material | 5/8" gypsum | | |
| Size | 3 5/8" Steel Stud | | |
| Spacing | 16" oc | | |
| Product | AFB | | |
| Thickness | 3" | | |

Insulation Included:
ROCKWOOL AFB



STC
45

| Acoustics | | Assembly Number: ISS-08 | |
|---------------------|-------------------|-------------------------|----|
| STC: | 45 | OITC: | 29 |
| Report No. | NWTL140829-01 | | |
| Assembly Components | | | |
| Finish material | 5/8" gypsum | | |
| Size | 3 5/8" Steel Stud | | |
| Spacing | 16" oc | | |
| Product | AFB | | |
| Thickness | 3.5" | | |
| Resilient Channels | RC Deluxe, 16" OC | | |

Insulation Included:
ROCKWOOL AFB



STC
45

| Acoustics | | Assembly Number: ISS-09 | |
|---------------------|---------------------------|-------------------------|--------------|
| STC: | 45 | Report No. | RAL-TL03-303 |
| Assembly Components | | | |
| Finish material | 5/8" gypsum | | |
| Size | 2 1/2" Steel Stud | | |
| Spacing | 24" oc | | |
| Product | AFB | | |
| Thickness | 1.5" | | |
| Penetrations | Electrical Boxes Included | | |

Insulation Included:
ROCKWOOL AFB

Interior Steel Stud Assemblies



STC
45

| Acoustics | | Assembly Number: ISS-10 | |
|---------------------|-------------------|-------------------------|--------------|
| STC: | 45 | Report No. | RAL-TL90-192 |
| Assembly Components | | | |
| Finish material | 1/2" Gypsum | | |
| Size | 2 1/2" Steel Stud | | |
| Spacing | 24" oc | | |
| Product | AFB | | |
| Thickness | 1.5" | | |

Insulation Included:
ROCKWOOL AFB

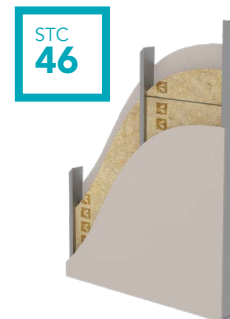

STC
46

| Acoustics | | Assembly Number: ISS-11 | |
|---------------------|-------------------|-------------------------|--------------|
| STC: | 46 | Report No. | RAL-TL90-195 |
| Assembly Components | | | |
| Finish material | 1/2" gypsum | | |
| Size | 3 5/8" Steel Stud | | |
| Spacing | 24" oc | | |
| Product | AFB | | |
| Thickness | 1.5" | | |

Insulation Included:
ROCKWOOL AFB

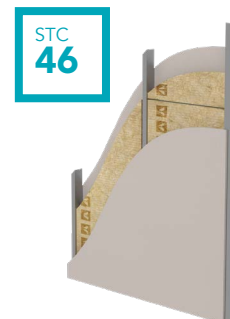

STC
46

| Acoustics | | Assembly Number: ISS-12 | |
|---------------------|-------------------|-------------------------|--------------|
| STC: | 46 | Report No. | RAL-TL02-212 |
| Assembly Components | | | |
| Finish material | 5/8" gypsum | | |
| Size | 2 1/2" Steel Stud | | |
| Spacing | 24" oc | | |
| Product | AFB | | |
| Thickness | 1.5" | | |

Insulation Included:
ROCKWOOL AFB

Interior Steel Stud Assemblies

STC
46



| Acoustics | | Assembly Number: ISS-13 | |
|---------------------|-------------------|-------------------------|--------------|
| STC: | 46 | Report No. | RAL-TL96-270 |
| Assembly Components | | | |
| Finish material | 5/8" gypsum | | |
| Size | 2 1/2" Steel Stud | | |
| Spacing | 24" oc | | |
| Product | AFB | | |
| Thickness | 2.5" | | |

Insulation Included:
ROCKWOOL AFB

STC
47

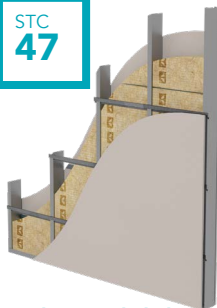

| Acoustics | | Assembly Number: ISS-14 | |
|---------------------|--------------------|-------------------------|----|
| STC: | 47 | OITC: | 29 |
| Report No. | J2247-12-303-11-R0 | | |
| Assembly Components | | | |
| Finish material | 1/2" gypsum | | |
| Size | 3 5/8" Steel Stud | | |
| Spacing | 16" oc | | |
| Product | AFB | | |
| Thickness | 3" | | |
| Resilient Channels | RC Deluxe, 16" OC | | |

Insulation Included:
ROCKWOOL AFB

STC
47

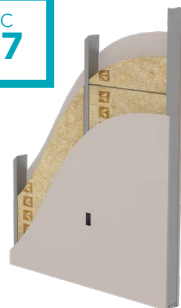

| Acoustics | | Assembly Number: ISS-15 | |
|---------------------|---------------------------|-------------------------|--------------|
| STC: | 47 | Report No. | RAL-TL03-306 |
| Assembly Components | | | |
| Finish material | 5/8" gypsum | | |
| Size | 3 5/8" Steel Stud | | |
| Spacing | 24" oc | | |
| Product | AFB | | |
| Thickness | 3" | | |
| Penetrations | Electrical Boxes Included | | |

Insulation Included:
ROCKWOOL AFB

Interior Steel Stud Assemblies

STC
47

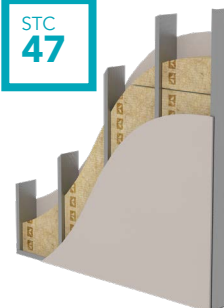

| Acoustics | | Assembly Number: ISS-16 | |
|---------------------|--------------------|-------------------------|----|
| STC: | 47 | OITC: | 29 |
| Report No. | J2247-05-303-11-R0 | | |
| Assembly Components | | | |
| Finish material | 1/2" Gypsum | | |
| Size | 6" Steel Stud | | |
| Spacing | 16" oc | | |
| Product | AFB | | |
| Thickness | 6" | | |

Insulation Included:
ROCKWOOL AFB

STC
49



| Acoustics | | Assembly Number: ISS-17 | |
|---------------------|-------------------|-------------------------|----|
| STC: | 49 | OITC: | 30 |
| Report No. | NWTL140827-04 | | |
| Assembly Components | | | |
| Finish material | 5/8" gypsum | | |
| Size | 3 5/8" Steel Stud | | |
| Spacing | 24" oc | | |
| Product | AFB | | |
| Thickness | 3.5" | | |

Insulation Included:
ROCKWOOL AFB

STC
49



| Acoustics | | Assembly Number: ISS-18 | |
|---------------------|---|-------------------------|----|
| STC: | 49 | OITC: | 32 |
| Report No. | NWTL140828-02 | | |
| Assembly Components | | | |
| Finish material | 5/8" gypsum | | |
| Size | 3 5/8" Steel Stud | | |
| Spacing | 24" oc | | |
| Product | Comfortboard 80 (outboard, single side) | | |
| Thickness | 3" | | |

Insulation Included:
ROCKWOOL Comfortboard 80
(outboard, single side)

Interior Steel Stud Assemblies

STC
50



| Acoustics | | Assembly Number: ISS-19 | |
|---------------------|-------------------|-------------------------|----|
| STC: | 50 | OITC: | 30 |
| Report No. | F0256.01B | | |
| Assembly Components | | | |
| Finish material | 5/8" gypsum | | |
| Size | 3 5/8" Steel Stud | | |
| Spacing | 24" oc | | |
| Product | AFB | | |
| Thickness | 3.5" | | |

Insulation Included:
ROCKWOOL AFB

STC
50

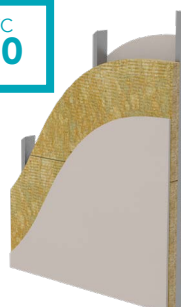

| Acoustics | | Assembly Number: ISS-20 | |
|---------------------|---|-------------------------|----|
| STC: | 50 | OITC: | 31 |
| Report No. | NWTL141118-04 | | |
| Assembly Components | | | |
| Finish material | 5/8" gypsum | | |
| Size | 3 5/8" Steel Stud | | |
| Spacing | 24" oc | | |
| Product | Minimum 4 pcf mineral wool board insulation (outboard, single side) | | |
| Thickness | 3" | | |

Insulation Included:
ROCKWOOL 4 pcf mineral
wool board insulation

STC
50

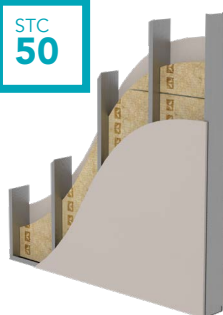

| Acoustics | | Assembly Number: ISS-21 | |
|---------------------|--------------------|-------------------------|----|
| STC: | 50 | OITC: | 34 |
| Report No. | J2247-04-303-11-R0 | | |
| Assembly Components | | | |
| Finish material | 5/8" gypsum | | |
| Size | 6" Steel Stud | | |
| Spacing | 16" oc | | |
| Product | AFB | | |
| Thickness | 3" | | |

Insulation Included:
ROCKWOOL AFB

Interior Steel Stud Assemblies

STC
50



| Acoustics | | Assembly Number: ISS-22 | |
|---------------------|--|-------------------------|--------------|
| STC: | 50 | Report No. | RAL-TL90-186 |
| Assembly Components | | | |
| Finish material | 1/2" gypsum, 2x 1/2" gypsum on single side | | |
| Size | 2 1/2" Steel Stud | | |
| Spacing | 24" oc | | |
| Product | AFB | | |
| Thickness | 1.5" | | |

Insulation Included:
ROCKWOOL AFB

STC
51



| Acoustics | | Assembly Number: ISS-23 | |
|---------------------|-------------------|-------------------------|--------------|
| STC: | 51 | Report No. | RAL-TL96-269 |
| Assembly Components | | | |
| Finish material | 1/2" gypsum | | |
| Size | 3 5/8" Steel Stud | | |
| Spacing | 24" oc | | |
| Product | AFB | | |
| Thickness | 3" | | |

Insulation Included:
ROCKWOOL AFB

STC
51



| Acoustics | | Assembly Number: ISS-24 | |
|---------------------|-------------------|-------------------------|----|
| STC: | 51 | OITC: | 31 |
| Report No. | NWTL141119-01 | | |
| Assembly Components | | | |
| Finish material | 5/8" gypsum | | |
| Size | 3 5/8" Steel Stud | | |
| Spacing | 24" oc | | |
| Product | AFB | | |
| Thickness | 3" | | |

Insulation Included:
ROCKWOOL AFB

Interior Steel Stud Assemblies



STC
52

Acoustics Assembly Number: ISS-25

STC: 52 OITC: 35 Report No. J2247-03-303-11-R0

Assembly Components

| | |
|-----------------|---------------|
| Finish material | 5/8" gypsum |
| Size | 6" Steel Stud |
| Spacing | 16" oc |
| Product | AFB |
| Thickness | 6" |

Insulation Included:
ROCKWOOL AFB



STC
53

Acoustics Assembly Number: ISS-26

STC: 53 Report No. RAL-TL96-288

Assembly Components

| | |
|-----------------|-------------------|
| Finish material | 1/2" gypsum |
| Size | 3 5/8" Steel Stud |
| Spacing | 24" oc |
| Product | AFB |
| Thickness | 3" |

Insulation Included:
ROCKWOOL AFB

Resilient Channels
Metal, 24" OC



STC
53

Acoustics Assembly Number: ISS-27

STC: 53 OITC: 34 Report No. J2247.10-303-11-R0

Assembly Components

| | |
|-----------------|-------------------|
| Finish material | 5/8" gypsum |
| Size | 3 5/8" Steel Stud |
| Spacing | 16" oc |
| Product | AFB |
| Thickness | 3" |

Insulation Included:
ROCKWOOL AFB

Resilient Channels
RC Deluxe, 16" OC

Interior Steel Stud Assemblies



STC
53

Acoustics Assembly Number: ISS-28

STC: 53 Report No. RAL-TL90-185

Assembly Components

| | |
|-----------------|-------------------|
| Finish material | 2x 1/2" gypsum |
| Size | 2 1/2" Steel Stud |
| Spacing | 24" oc |
| Product | AFB |
| Thickness | 1.5" |

Insulation Included:
ROCKWOOL AFB



STC
54

Acoustics Assembly Number: ISS-29

STC: 54 OITC: 37 Report No. J2247.08-303-11-R0

Assembly Components

| | |
|-----------------|---------------|
| Finish material | 5/8" gypsum |
| Size | 6" Steel Stud |
| Spacing | 24" oc |
| Product | AFB |
| Thickness | 3" |

Insulation Included:
ROCKWOOL AFB

Resilient Channels
RC Deluxe, 16" OC



STC
54

Acoustics Assembly Number: ISS-30

STC: 54 OITC: 35 Report No. J2247.02-303-11-R0

Assembly Components

| | |
|-----------------|---------------|
| Finish material | 5/8" gypsum |
| Size | 6" Steel Stud |
| Spacing | 16" oc |
| Product | AFB |
| Thickness | 3" |

Insulation Included:
ROCKWOOL AFB

Resilient Channels
RC Deluxe, 16" OC

Interior Steel Stud Assemblies



STC
55

Acoustics Assembly Number: ISS-31

STC: 55 Report No. RAL-TL96-289

Assembly Components

Finish material 5/8" gypsum
Size 3 5/8" Steel Stud
Spacing 24" oc
Product AFB
Thickness 3"

Resilient Channels Metal, 24" OC

Insulation Included:
ROCKWOOL AFB



STC
55

Acoustics Assembly Number: ISS-32

STC: 55 OITC: 35 Report No. NWT140827-03

Assembly Components

Finish material 5/8" gypsum, 2x 5/8" gypsum on single side
Size 3 5/8" Steel Stud
Spacing 24" oc
Product AFB
Thickness 3.5"

Insulation Included:
ROCKWOOL AFB



STC
55

Acoustics Assembly Number: ISS-33

STC: 55 Report No. RAL-TL02-296

Assembly Components

Finish material 5/8" gypsum
Size 6" Steel Stud
Spacing 24" oc
Product AFB
Thickness 6"

Insulation Included:
ROCKWOOL AFB

Interior Steel Stud Assemblies



STC
56

Acoustics Assembly Number: ISS-34

STC: 56 Report No. RAL-TL96-264

Assembly Components

Finish material 5/8" gypsum, 2x 5/8" gypsum on single side
Size 3 5/8" Steel Stud
Spacing 24" oc
Product AFB
Thickness 3.5"

Insulation Included:
ROCKWOOL AFB



STC
56

Acoustics Assembly Number: ISS-35

STC: 56 Report No. RAL-TL90-196

Assembly Components

Finish material 2x 1/2" gypsum
Size 3 5/8" Steel Stud
Spacing 24" oc
Product AFB
Thickness 1.5"

Insulation Included:
ROCKWOOL AFB

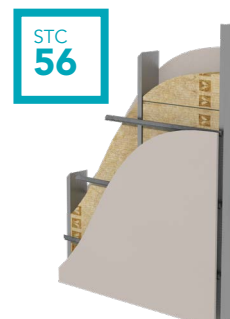

STC
56

Acoustics Assembly Number: ISS-36

STC: 56 OITC: 39 Report No. J2247.07-303-11-R0

Assembly Components

Finish material 5/8" gypsum
Size 6" Steel Stud
Spacing 24" oc
Product AFB
Thickness 6"

Insulation Included:
ROCKWOOL AFB

Resilient Channels RC Deluxe, 16" OC

Interior Steel Stud Assemblies

STC 56

| | | | |
|---------------------|--------------------|-------------------------|----|
| Acoustics | | Assembly Number: ISS-37 | |
| STC: | 56 | OITC: | 39 |
| Report No. | J2247.01-303-11-R0 | | |
| Assembly Components | | | |
| Finish material | 5/8" gypsum | | |
| Size | 6" Steel Stud | | |
| Spacing | 16" oc | | |
| Product | AFB | | |
| Thickness | 6" | | |
| Resilient Channels | RC Deluxe, 16" OC | | |

Insulation Included:
ROCKWOOL AFB

STC 56

| | | | |
|---------------------|-------------------|-------------------------|--------------|
| Acoustics | | Assembly Number: ISS-38 | |
| STC: | 56 | Report No. | RAL-TL90-193 |
| Assembly Components | | | |
| Finish material | 2x 5/8" gypsum | | |
| Size | 2 1/2" Steel Stud | | |
| Spacing | 24" oc | | |
| Product | AFB | | |
| Thickness | 1.5" | | |

Insulation Included:
ROCKWOOL AFB

STC 56

| | | | |
|---------------------|---|-------------------------|----|
| Acoustics | | Assembly Number: ISS-40 | |
| STC: | 56 | OITC: | 36 |
| Report No. | RAL-TL23-194 | | |
| Assembly Components | | | |
| Finish material | 5/8" gypsum, 2 x 5/8" gypsum on single side | | |
| Size | 6" Steel Stud | | |
| Spacing | 24" oc | | |
| Product | AFB | | |
| Thickness | 3" | | |

Insulation Included:
ROCKWOOL AFB

Interior Steel Stud Assemblies

STC 57

| | | | |
|---------------------|-------------------|-------------------------|--------------|
| Acoustics | | Assembly Number: ISS-39 | |
| STC: | 57 | Report No. | RAL-TL96-268 |
| Assembly Components | | | |
| Finish material | 2x 5/8" gypsum | | |
| Size | 3 5/8" Steel Stud | | |
| Spacing | 24" oc | | |
| Product | AFB | | |
| Thickness | 3" | | |

Insulation Included:
ROCKWOOL AFB

STC 57

| | | | |
|---------------------|--|-------------------------|----|
| Acoustics | | Assembly Number: ISS-41 | |
| STC: | 57 | OITC: | 38 |
| Report No. | RAL-TL23-195 | | |
| Assembly Components | | | |
| Finish material | 5/8" gypsum, 2x 5/8" gypsum on single side | | |
| Size | 6" Steel Stud | | |
| Spacing | 24" oc | | |
| Product | AFB | | |
| Thickness | 6" | | |

Insulation Included:
ROCKWOOL AFB

Interior Wood Stud Assemblies

This section will outline interior assemblies using wood studs in various thicknesses, spacings, finishes, and any additional components. Assemblies will be organized by STC value ranging from an STC of 36 to an STC of 66.



STC
36

Insulation Included:
ROCKWOOL
Safe'n'Sound/AFB

Acoustics Assembly Number: IWS-15

STC: 36 OITC: 27 Report No. TL21-355

Assembly Components

Finish material 5/8" type X gypsum

Size 2x6 Wood Stud

Spacing 16" oc

Product Safe'n'Sound/AFB

Thickness 3"

Wall Configuration Single Stud



STC
37

Insulation Included:
ROCKWOOL Comfortbatt

Acoustics Assembly Number: IWS-01

STC: 37 Report No. NGC 2011011

Assembly Components

Finish material 5/8" type X gypsum

Size 2 x 4 Wood Stud

Spacing 16" oc

Product Comfortbatt

Thickness 3.5"

Wall Configuration Single Stud



STC
38

Insulation Included:
ROCKWOOL
Safe'n'Sound/AFB

Acoustics Assembly Number: IWS-16

STC: 38 OITC: 28 Report No. TL21-356

Assembly Components

Finish material 5/8" Type X gypsum

Size 2 x 6 Wood Stud

Spacing 16" oc

Product Safe'n'Sound/AFB

Thickness 5.5"

Wall Configuration Single Stud

Interior Wood Stud Assemblies



STC
38

Insulation Included:
ROCKWOOL AFB

Acoustics Assembly Number: IWS-02

STC: 38 Report No. RAL-TL96-265

Assembly Components

Finish material 5/8" gypsum

Size 2 x 4 Wood Stud

Spacing 16" oc

Product AFB

Thickness 3"

Wall Configuration Single Stud



STC
38

Insulation Included:
ROCKWOOL AFB

Acoustics Assembly Number: IWS-03

STC: 38 Report No. RAL-TL96-266

Assembly Components

Finish material 1/2" gypsum

Size 2 x 4 Wood Stud

Spacing 16" oc

Product AFB

Thickness 3"

Wall Configuration Single Stud



STC
40

Insulation Included:
ROCKWOOL AFB

Acoustics Assembly Number: IWS-04

STC: 40 OITC: 32 Report No.

Assembly Components

Finish material 2 x 5/8" gypsum

Size 2 x 4 Wood Stud

Spacing 16" oc

Product AFB

Thickness 3"

Wall Configuration Single Stud

Interior Wood Stud Assemblies



Insulation Included:
ROCKWOOL Comfortbatt

| Acoustics | | Assembly Number: IWS-05 | |
|---------------------|-----------------|-------------------------|-------------|
| STC: | 40 | Report No. | NGC 2011013 |
| Assembly Components | | | |
| Finish material | 1/2" gypsum | | |
| Size | 2 x 4 Wood Stud | | |
| Spacing | 16" oc | | |
| Product | Comfortbatt | | |
| Thickness | 3.5" | | |
| Wall Configuration | Single Stud | | |

Interior Wood Stud Assemblies



Insulation Included:
ROCKWOOL
Safe'n'Sound/AFB

| Acoustics | | Assembly Number: IWS-17 | |
|---------------------|-----------------------|-------------------------|----|
| STC: | 48 | OITC: | 31 |
| Report No. | TL21-358 | | |
| Assembly Components | | | |
| Finish material | 2x 5/8" Type X gypsum | | |
| Size | 2 x 6 Wood Stud | | |
| Spacing | 24" oc | | |
| Product | Safe'n'Sound/AFB | | |
| Thickness | 3" | | |
| Wall Configuration | Single Stud | | |



Insulation Included:
ROCKWOOL AFB

| Acoustics | | Assembly Number: IWS-06 | |
|---------------------|-----------------|-------------------------|--------------|
| STC: | 45 | Report No. | RAL-TL02-300 |
| Assembly Components | | | |
| Finish material | 5/8" gypsum | | |
| Size | 2 x 6 Wood Stud | | |
| Spacing | 24" oc | | |
| Product | AFB | | |
| Thickness | 5.5" | | |
| Wall Configuration | Single Stud | | |



Insulation Included:
ROCKWOOL
Safe'n'Sound/AFB

| Acoustics | | Assembly Number: IWS-18 | |
|---------------------|-----------------------|-------------------------|----|
| STC: | 48 | OITC: | 32 |
| Report No. | TL21-359 | | |
| Assembly Components | | | |
| Finish material | 2x 5/8" Type X gypsum | | |
| Size | 2 x 6 Wood Stud | | |
| Spacing | 24" oc | | |
| Product | Safe'n'Sound/AFB | | |
| Thickness | 5.5" | | |
| Wall Configuration | Single Stud | | |



Insulation Included:
ROCKWOOL AFB

| Acoustics | | Assembly Number: IWS-07 | |
|---------------------|--------------------------------|-------------------------|----|
| STC: | 47 | OITC: | 33 |
| Report No. | K2356.06-303-11-R0 | | |
| Assembly Components | | | |
| Finish material | 5/8" gypsum | | |
| Size | 2 x 4 Wood Stud | | |
| Spacing | 16" oc | | |
| Product | AFB | | |
| Thickness | 3" | | |
| Resilient Channels | RC Deluxe, 16" oc, Single Stud | | |

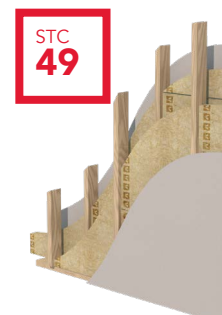

Insulation Included:
ROCKWOOL Comfortbatt

| Acoustics | | Assembly Number: IWS-08 | |
|---------------------|-----------------|-------------------------|-------------|
| STC: | 49 | Report No. | NGC 2011015 |
| Assembly Components | | | |
| Finish material | 1/2" gypsum | | |
| Size | 2 x 4 Wood Stud | | |
| Spacing | 24" oc | | |
| Product | Comfortbatt | | |
| Thickness | 2.5" per row | | |
| Wall Configuration | Staggered Studs | | |

Interior Wood Stud Assemblies

STC
50



| Acoustics | | Assembly Number: IWS-19 | |
|---------------------|--------------------------------------|-------------------------|----|
| STC: | 50 | OITC: | 35 |
| Report No. | TL21-351 | | |
| Assembly Components | | | |
| Finish material | 5/8" Type X gypsum | | |
| Size | 2 x 4 Wood Stud | | |
| Spacing | 16" oc | | |
| Product | Safe'n'Sound/AFB | | |
| Thickness | 3" per row, notched at opposing stud | | |
| Wall Configuration | Staggered Studs | | |

Insulation Included:
ROCKWOOL
Safe'n'Sound/AFB

STC
50



| Acoustics | | Assembly Number: IWS-09 | |
|---------------------|--------------------|-------------------------|-------------|
| STC: | 50 | Report No. | NGC 2011014 |
| Assembly Components | | | |
| Finish material | 5/8" type X gypsum | | |
| Size | 2 x 4 Wood Stud | | |
| Spacing | 24" oc | | |
| Product | Comfortbatt | | |
| Thickness | 2.5" per row | | |
| Wall Configuration | Staggered Studs | | |

Insulation Included:
ROCKWOOL Comfortbatt

STC
51



| Acoustics | | Assembly Number: IWS-10 | |
|---------------------|--------------------|-------------------------|-------------|
| STC: | 51 | Report No. | NGC 2011016 |
| Assembly Components | | | |
| Finish material | 5/8" type X gypsum | | |
| Size | 2 x 4 Wood Stud | | |
| Spacing | 24" oc | | |
| Product | AFB | | |
| Thickness | 2" per row | | |
| Wall Configuration | Staggered Studs | | |

Insulation Included:
ROCKWOOL AFB

Interior Wood Stud Assemblies

STC
52



| Acoustics | | Assembly Number: IWS-11 | |
|---------------------|-----------------------------|-------------------------|-------------|
| STC: | 52 | Report No. | NGC 2010072 |
| Assembly Components | | | |
| Finish material | 1/2" gypsum | | |
| Size | 2 x 4 Wood Stud | | |
| Spacing | 16" oc | | |
| Product | Comfortbatt | | |
| Thickness | 3.5" per row | | |
| Wall Configuration | Double Stud with 1" Air Gap | | |

Insulation Included:
ROCKWOOL Comfortbatt

STC
53



| Acoustics | | Assembly Number: IWS-20 | |
|---------------------|--------------------|-------------------------|----|
| STC: | 53 | OITC: | 37 |
| Report No. | TL21-357 | | |
| Assembly Components | | | |
| Finish material | 5/8" Type X gypsum | | |
| Size | 2 x 6 Wood Stud | | |
| Spacing | 16" oc | | |
| Product | Safe'n'Sound/AFB | | |
| Thickness | 5.5" | | |
| Wall Configuration | Single Stud | | |
| Resilient Channels | 24" oc | | |

Insulation Included:
ROCKWOOL
Safe'n'Sound/AFB

STC
54



| Acoustics | | Assembly Number: IWS-21 | |
|---------------------|--------------------------------------|-------------------------|----|
| STC: | 54 | OITC: | 48 |
| Report No. | TL21-353 | | |
| Assembly Components | | | |
| Finish material | 2x 5/8" Type X gypsum | | |
| Size | 2 x 4 Wood Stud | | |
| Spacing | 24" oc | | |
| Product | Safe'n'Sound/AFB | | |
| Thickness | 3" per row, notched at opposing stud | | |
| Wall Configuration | Staggered Studs | | |

Insulation Included:
ROCKWOOL
Safe'n'Sound/AFB

Interior Wood Stud Assemblies



STC
56

Insulation Included:
ROCKWOOL Safe'n'Sound

Acoustics Assembly Number: IWS-12

STC: 56 Report No. NGC 2010071

Assembly Components

Finish material 5/8" type X gypsum

Size 2 x 4 Wood Stud

Spacing 16" oc

Product Safe'n'Sound

Thickness 3" per row

Wall Configuration Double Stud with 1" Air Gap



STC
57

Insulation Included:
ROCKWOOL
Safe'n'Sound/AFB

Acoustics Assembly Number: IWS-22

STC: 57 OITC: 38 Report No. TL21-352

Assembly Components

Finish material 5/8" Type X gypsum

Size 2 x 4 Wood Stud

Spacing 16" oc

Product Safe'n'Sound/AFB

Thickness 3" per row, notched at opposing stud

Wall Configuration Staggered Studs

Resilient Channels 24" oc



STC
58

Insulation Included:
ROCKWOOL Comfortbatt
ROXUL Safe 45

Acoustics Assembly Number: IWS-13

STC: 58 OITC: 33 Report No. NGC 2010070

Assembly Components

Finish material 5/8" type X gypsum

Size 2 x 4 Wood Stud

Spacing 16" oc

Product Comfortbatt

Thickness 3.5" per row

Wall Configuration Double Stud with 1" ROXUL Safe 45

Interior Wood Stud Assemblies

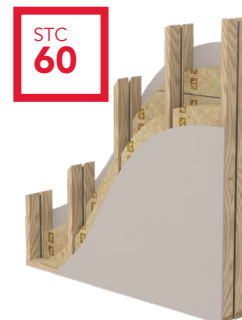

STC
60

Insulation Included:
ROCKWOOL Comfortbatt

Acoustics Assembly Number: IWS-14

STC: 60 Report No. NGC 2010069

Assembly Components

Finish material 5/8" type X gypsum

Size 2 x 4 Wood Stud

Spacing 16" oc

Product Comfortbatt

Thickness 3.5" per row

Wall Configuration Double Stud with 1" Air Gap



STC
61

Insulation Included:
ROCKWOOL
Safe'n'Sound/AFB

Acoustics Assembly Number: IWS-23

STC: 61 OITC: 46 Report No. TL21-360

Assembly Components

Finish material 2x 5/8" Type X gypsum

Size 2 x 6 Wood Stud

Spacing 24" oc

Product Safe'n'Sound/AFB

Thickness 5.5"

Wall Configuration Single Stud

Resilient Channels 24" oc



STC
66

Insulation Included:
ROCKWOOL
Safe'n'Sound/AFB

Acoustics Assembly Number: IWS-24

STC: 66 OITC: 50 Report No. TL21-349

Assembly Components

Finish material 2x 5/8" Type X gypsum

Size 2 x 4 Wood Stud

Spacing 16" oc

Product Safe'n'Sound/AFB

Thickness 3" per row

Wall Configuration Double Stud with 1" Air Gap

Interior Wood Stud Assemblies

Exterior Wood Stud Assemblies

This section will outline exterior assemblies using wood studs in various thicknesses, spacings, finishes, and any additional components. Assemblies will be organized by STC value ranging from an STC of 35 to an STC of 39.



STC
66

Acoustics Assembly Number: IWS-25

STC: 66 OITC: 52 Report No. TL21-350

Assembly Components

Finish material 2x 5/8" Type X gypsum

Size 2 x 4 Wood Stud

Spacing 24" oc

Product Safe'n'Sound/AFB

Thickness 3" per row

Wall Configuration Double Stud with 1" Air Gap

Insulation Included:
ROCKWOOL
Safe'n'Sound/AFB



STC
66

Acoustics Assembly Number: IWS-26

STC: 66 OITC: 51 Report No. TL21-354

Assembly Components

Finish material 2x 5/8" Type X gypsum

Size 2 x 4 Wood Stud

Spacing 24" oc

Product Safe'n'Sound/AFB

Thickness 3" per row, notched at opposing stud

Wall Configuration Staggered Studs, on 2x6 plates

Resilient Channels 16" oc

Insulation Included:
ROCKWOOL
Safe'n'Sound/AFB



STC
35

Acoustics Assembly Number: EWS-01

STC: 35 OITC: 27 Report No. H5383.01-113-11-R0

Assembly Components

Finish material 5/8" gypsum

Size 2 x 6 Wood Stud

Spacing 16" oc

Product Comfortbatt

Thickness 6"

Sheathing 1/2 plywood with Air Barrier

Continuous Insulation .

Insulation Thickness .

Insulation Fastening .

Insulation Included:
ROCKWOOL Comfortbatt



STC
39

Acoustics Assembly Number: EWS-02

STC: 39 OITC: 29 Report No. H5383.02-113-11-R0

Assembly Components

Finish material 5/8" gypsum

Size 2 x 6 Wood Stud

Spacing 16" oc

Product Comfortbatt

Thickness 6"

Sheathing 1/2 plywood with Air Barrier

Continuous Insulation Comfortboard 80

Insulation Thickness 1.5

Insulation Fastening Furring Strips

Insulation Included:
ROCKWOOL Comfortbatt
ROCKWOOL Comfortboard 80

Looking for building science support?
ROCKWOOL is here to help with a full range of building modeling to help with your project.

Visit: rockwool.com/buildingscience for more information



Exterior Steel Stud Assemblies

This section will outline exterior assemblies using steel studs in various thicknesses, spacings, finishes, and any additional components. Assemblies will be organized by STC value ranging from an STC of 43 to an STC of 52.



Insulation Included:
ROCKWOOL
Comfortboard 110

| Acoustics | | Assembly Number: ESS-01 | |
|-----------------------|------------------------------|-------------------------|----|
| STC: | 43 | OITC: | 30 |
| Report No. | H5383.06-113-11-R0 | | |
| Assembly Components | | | |
| Finish material | 5/8" gypsum | | |
| Size | 3 5/8" Steel Stud | | |
| Spacing | 16" oc | | |
| Batt Product | . | | |
| Thickness | . | | |
| Sheathing | 1/2" gypsum with Air Barrier | | |
| Continuous Insulation | Comfortboard 110 | | |
| Insulation Thickness | 1" | | |
| Insulation Fastening | Furring Strips | | |
| Cladding | None | | |



Insulation Included:
ROCKWOOL Cavityrock

| Acoustics | | Assembly Number: ESS-02 | |
|-----------------------|------------------------------|-------------------------|----|
| STC: | 44 | OITC: | 29 |
| Report No. | 96973.01-113-11 | | |
| Assembly Components | | | |
| Finish material | 1/2" gypsum | | |
| Size | 6" Steel Stud | | |
| Spacing | 16" oc | | |
| Batt Product | . | | |
| Thickness | . | | |
| Sheathing | 5/8" gypsum with Air Barrier | | |
| Continuous Insulation | Cavityrock | | |
| Insulation Thickness | 3" | | |
| Insulation Fastening | Z-girts | | |
| Cladding | 5/16" Cement Board | | |

Exterior Steel Stud Assemblies



Insulation Included:
ROCKWOOL Comfortbatt
Polyiso Insulation

| Acoustics | | Assembly Number: ESS-03 | |
|-----------------------|------------------------------|-------------------------|----|
| STC: | 47 | OITC: | 30 |
| Report No. | 96641.01-113-11 | | |
| Assembly Components | | | |
| Finish material | 1/2" gypsum | | |
| Size | 6" Steel Stud | | |
| Spacing | 16" oc | | |
| Batt Product | Comfortbatt | | |
| Thickness | 6" | | |
| Sheathing | 5/8" gypsum with Air Barrier | | |
| Continuous Insulation | Polyiso | | |
| Insulation Thickness | 3" | | |
| Insulation Fastening | Z-girts | | |
| Cladding | 5/16" Cement Board | | |



Insulation Included:
ROCKWOOL Comfortbatt

| Acoustics | | Assembly Number: ESS-04 | |
|-----------------------|------------------------------|-------------------------|----|
| STC: | 48 | OITC: | 30 |
| Report No. | 96642.01-113-11 | | |
| Assembly Components | | | |
| Finish material | 1/2" gypsum | | |
| Size | 6" Steel Stud | | |
| Spacing | 16" oc | | |
| Batt Product | Comfortbatt | | |
| Thickness | 6" | | |
| Sheathing | 5/8" gypsum with Air Barrier | | |
| Continuous Insulation | Air Gap | | |
| Insulation Thickness | . | | |
| Insulation Fastening | Z-girts | | |
| Cladding | 5/16" Cement Board | | |

Exterior Steel Stud Assemblies

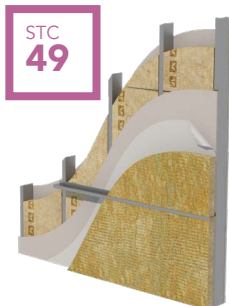

STC
49

| Acoustics | | Assembly Number: ESS-05 | |
|-----------------------|------------------------------|-------------------------|----|
| STC: | 49 | OITC: | 32 |
| Report No. | H5383.03-113-11-R0 | | |
| Assembly Components | | | |
| Finish material | 5/8" gypsum | | |
| Size | 3 5/8" Steel Stud | | |
| Spacing | 16" oc | | |
| Batt Product | Comfortbatt | | |
| Thickness | 3.5" | | |
| Sheathing | 5/8" gypsum with Air Barrier | | |
| Continuous Insulation | Cavityrock | | |
| Insulation Thickness | 2" | | |
| Insulation Fastening | Z-girts | | |
| Cladding | None | | |

Insulation Included:
ROCKWOOL Comfortbatt
ROCKWOOL Cavityrock

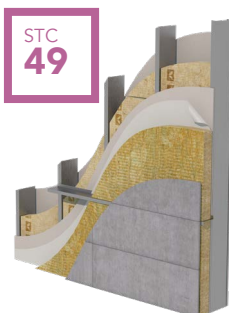

STC
49

| Acoustics | | Assembly Number: ESS-06 | |
|-----------------------|------------------------------|-------------------------|----|
| STC: | 49 | OITC: | 32 |
| Report No. | 97175.01-113-11 | | |
| Assembly Components | | | |
| Finish material | 5/8" gypsum | | |
| Size | 6" Steel Stud | | |
| Spacing | 16" oc | | |
| Batt Product | Comfortbatt | | |
| Thickness | 6" | | |
| Sheathing | 5/8" gypsum with Air Barrier | | |
| Continuous Insulation | Cavityrock | | |
| Insulation Thickness | 3" | | |
| Insulation Fastening | Z-girts | | |
| Cladding | 5/16" Cement Board | | |

Insulation Included:
ROCKWOOL Comfortbatt
ROCKWOOL Cavityrock

Exterior Steel Stud Assemblies



STC
50

| Acoustics | | Assembly Number: ESS-07 | |
|-----------------------|------------------------------|-------------------------|----|
| STC: | 50 | OITC: | 31 |
| Report No. | 96644.01-113-11 | | |
| Assembly Components | | | |
| Finish material | 1/2" gypsum | | |
| Size | 6" Steel Stud | | |
| Spacing | 16" oc | | |
| Batt Product | Comfortbatt | | |
| Thickness | 6" | | |
| Sheathing | 5/8" gypsum with Air Barrier | | |
| Continuous Insulation | Cavityrock | | |
| Insulation Thickness | 3" | | |
| Insulation Fastening | Z-girts | | |
| Cladding | 5/16" Cement Board | | |

Insulation Included:
ROCKWOOL Comfortbatt
ROCKWOOL Cavityrock

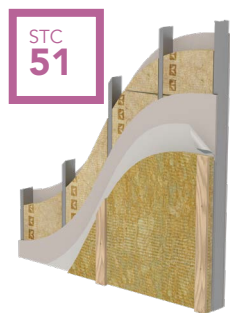

STC
51

| Acoustics | | Assembly Number: ESS-08 | |
|-----------------------|------------------------------|-------------------------|----|
| STC: | 51 | OITC: | 32 |
| Report No. | H5383.05-113-11-R0 | | |
| Assembly Components | | | |
| Finish material | 5/8" gypsum | | |
| Size | 3 5/8" Steel Stud | | |
| Spacing | 16" oc | | |
| Batt Product | Comfortbatt | | |
| Thickness | 3.5" | | |
| Sheathing | 1/2" gypsum with Air Barrier | | |
| Continuous Insulation | Comfortboard 110 | | |
| Insulation Thickness | 1" | | |
| Insulation Fastening | Furring Strips | | |
| Cladding | None | | |

Insulation Included:
ROCKWOOL Comfortbatt
ROCKWOOL Comfortboard 110

At the ROCKWOOL Group, we are committed to enriching the lives of everyone who comes into contact with our solutions. Our expertise is perfectly suited to tackle many of today's biggest sustainability and development challenges, from energy consumption and noise pollution to fire resilience, water scarcity and flooding. Our range of products reflects the diversity of the world's needs, while supporting our stakeholders in reducing their own carbon footprint.

Stone wool is a versatile material and forms the basis of all our businesses. With more than 11,000 employees in 39 countries, we are the world leader in stone wool solutions, from building insulation to acoustic ceilings, external cladding systems to horticultural solutions, engineered fibres for industrial use to insulation for the process industry and marine and offshore.

AFB®, Cavityrock®, Comfortbatt®, Comfortboard®, Conrock®, Curtainrock®, ROXUL Safe®, Rockboard®, Toprock®, Monoboard®, ROXUL® are registered trademarks of the ROCKWOOL Group in USA and ROXUL Inc. in Canada.

ROCKWOOL™, Fabrock™ are trademarks of the ROCKWOOL Group in USA and ROXUL Inc. in Canada.

SAFE'n'SOUND® is a registered trademark used under license by Masonite Inc.

06-2023



ROCKWOOL
8024 Esquesing Line
Milton, ON L9T 6W3
Tel: 1 800 265 6878
rockwool.com