

USG  
Ceiling  
Solutions

**USG PARALINE<sup>®</sup>**  
BAFFLE CUTTING  
INSTRUCTIONS



IT'S YOUR WORLD. BUILD IT.™

# SYSTEM OVERVIEW

---

## USG PARALINE® BAFFLES

USG Paraline® Baffles is a flexible and customizable linear metal system that can achieve numerous design aesthetics and is supported for a variety of installation requirements. It is integrated with an array of components and accessories to meet visual design and installation needs.

## NOTES

Follow proper safety and industrial hygiene practices while handling and installing all products and systems. Take necessary precautions and wear appropriate personal protective equipment as needed. When working with system components, we recommend wearing a dust mask, cut-resistant gloves and eye protection. Hearing protection should be used as needed. Provide drop cloths to cover and protect furnishings below. When using a ladder or lift, follow the equipment manufacturer's precautions, instructions and safety guidelines.

All ceiling products and systems must be installed and maintained in accordance with current USG written instructions and in compliance with ASTM C636, ASTM E580, CISCA and standard industry practices.

Care must be taken to safeguard products from damage during delivery and while they are stored at the job site. The products must always be protected from vibration, chemical fumes and direct contact with water including condensation both before and after installation.

## PARTS AND COMPONENTS

- USG Paraline Baffle
- Miter Saw
- High tooth count, carbide tipped metal cutting blade
- Standard 2x6 (6 in. Baffle)
- Standard 2x4 (4 in. Baffle)
- Tape measure
- T-square
- Pencil
- File

# CUTTING INSTRUCTIONS

---

## STEP 1

- For 6 in. USG Paraline Baffles, using miter saw or other appropriate cutting tool, cut two 6 in. long sections of 2x6 from overall length. For 4 in. USG Paraline Baffles, substitute a 2x4.

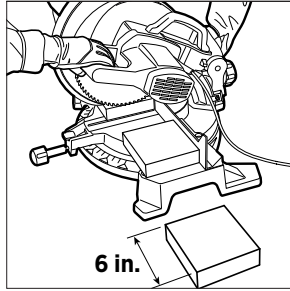

## STEP 2

- Using a miter saw or other appropriate cutting tool, rip 6 in. sections of 2x6 from original width of approximately 1-3/4 in. to slightly below 1-1/2 in. until the 2x6 can be easily inserted into the Baffle.

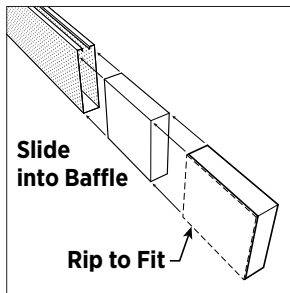

## STEP 3

- Mark desired cut location on the USG Paraline Baffle using a tape measure, T-square and pencil.

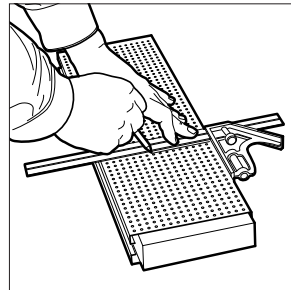
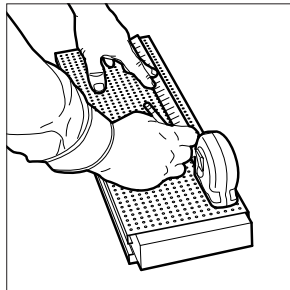

# CUTTING INSTRUCTIONS

---

- STEP 4**
- Position each 6 in. section of 2x4 on either side of the intended cut location.

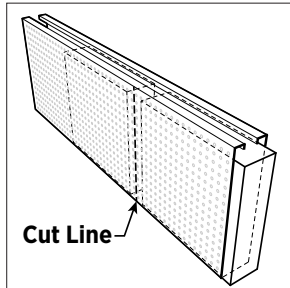

- STEP 5**
- Using the miter saw, with a high tooth count, carbide tipped metal cutting blade, cut Baffle at desired location.

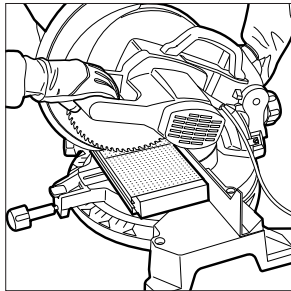

- STEP 6**
- As needed, use a file to touch up rough edges of the cut section.

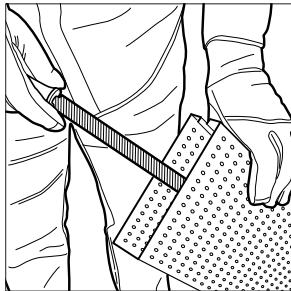

---

Repeat steps 1-6 using a standard 2x4 in place of recommended 2x6.





## PRODUCT INFORMATION

See [usg.com](http://usg.com) for the most up-to-date product information.

## CUSTOMER SERVICE

USG 800 950-3839  
CGC 800 387-2690

## TECHNICAL SERVICE

800 USG.4YOU (874-4968)

## WEBSITES

[usg.com](http://usg.com)  
[cgcinc.com](http://cgcinc.com)  
[usgdesignstudio.com](http://usgdesignstudio.com)  
[cgcdesignstudio.com](http://cgcdesignstudio.com)

## PRODUCT INFORMATION

Data Page: IC308  
System Guide: IC415  
See [usg.com](http://usg.com) or [cgcinc.com](http://cgcinc.com) for the most up-to-date product information.

## INSTALLATION

Must be installed in compliance with ASTM C636, ASTM E580, CISCA and standard industry practices, within all applicable code requirements. Alternative assemblies and installation methods may be utilized when approved by the authority having jurisdiction. USG recommends checking with the authority having jurisdiction prior to designing and installing a suspended ceiling system.

## CODE COMPLIANCE

The information presented is correct to the best of our knowledge at the date of issuance. Because codes continue to evolve, check with a local official prior to designing and installing a ceiling system. Other restrictions and exemptions may apply.

## NOTICE

We shall not be liable for incidental and consequential damages, directly or indirectly sustained, nor for any loss caused by application of these goods not in accordance with current printed instructions or for other than the intended use. Our liability is expressly limited to replacement of defective goods. Any claim shall be deemed waived unless made in writing to us within thirty (30) days from date it was or reasonably should have been discovered.

## COLOR VARIATIONS

Some commercially acceptable color variation may occur between lots and between different size products of the same color.

## SEISMIC APPLICATIONS

Refer to *Seismic Technical Guide, Specialty Decorative Ceilings (SC2494)* for more information on architectural components.

## SAFETY FIRST!

Follow good safety/industrial hygiene practices during installation. Wear appropriate personal protective equipment. Read SDS and literature before specification and installation.

## WARRANTY

One (1) year limited warranty. See *USG Ceilings Commercial Application Warranty (SC2102)* for additional details. For Canadian product needs, please contact your local sales representative.

IC718/2-18

© 2018 USG Corporation and/or its affiliates. All rights reserved.  
The trademarks USG, CGC, PARALINE, IT'S YOUR WORLD. BUILD IT., the USG/CGC logo, the design elements and colors, and related marks are trademarks of USG Corporation or its affiliates.

## NOTICE

The information in this document is subject to change without notice. CGC Inc. or USG Corp. assumes no responsibility for any errors that may inadvertently appear in this document.



IT'S YOUR WORLD. BUILD IT.™