

VCS/VCE Venting Skylight

Technical Product Data Sheet

VELUX®

Description

- VCS/VCE Venting Curb Mount Solar/Electric Skylight that mounts to a site-built curb (residential curbs typically 2x4 or 2x6). Venting skylight, provided with various glazings, is manufactured with a white PVC frame/sash a neutral gray aluminum profile, and an insulated glass unit.

Installation

- Designated top, bottom, and sides for installation in one direction.
- Single unit applications only (combination applications not possible).
- 0 degrees to 60 degrees, use standard installation procedure.
- Above 45 degrees, use water diverter as illustrated in installation instructions; water diverter provided by installer.
- Includes insect screen.
- VCE includes 20ft of 14-gauge electrical cable, an internal rain sensor, and KLI 311 remote.
- VCS includes solar panel/ acoustic rain sensor, and KLI 311 remote.

Flashings

- ECL - Engineered neutral gray flashing for single installation with thin roofing material ($\frac{1}{2}$ " max) for roof pitch above 10-60 degrees.
- ECW - Engineered neutral gray flashing for single installation with tile (over $\frac{3}{4}$ ") roofing material for roof pitch above 14-60 degrees.
- Applications less than 10-degree roof pitch - flashing provided by others.

Interior Accessories

- FSCC - Solar powered Room darkening - double pleated shade.
- FSLC - Solar powered Light filtering - single pleated shade.

Type Sign

- Example: VCE 2222 0004E 01BM05
- Etched into bottom right of exterior frame cover.

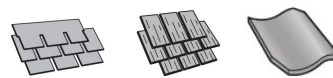

Standard Sizes

- 2222, 2234, 2246, 3030, 3046, 3434, 4622, 4646

Special Sizes

- No custom sizes available.

Warranty

- **Installation** – 10 years from the date of purchase; VELUX No Leak Warranty warrants skylight installation. Must be installed with VELUX flashings and included adhesive underlayment.
- **Skylight** – 10 years from the date of purchase; VELUX warrants that the skylight will be free from defects in material and workmanship.
- **Glass Seal** – 20 years from the date of purchase; VELUX warrants that the insulated glass pane will not develop a material obstruction of vision due to failure of the glass seal.
- **Hail Warranty** – 10 years from the date of purchase; VELUX warrants only laminated glass panes against hail breakage.
- **Accessories and Electrical Components** – 5 years from the date of purchase; VELUX warrants Velux shades and control systems will be free from defects in material and workmanship.

Cross Section

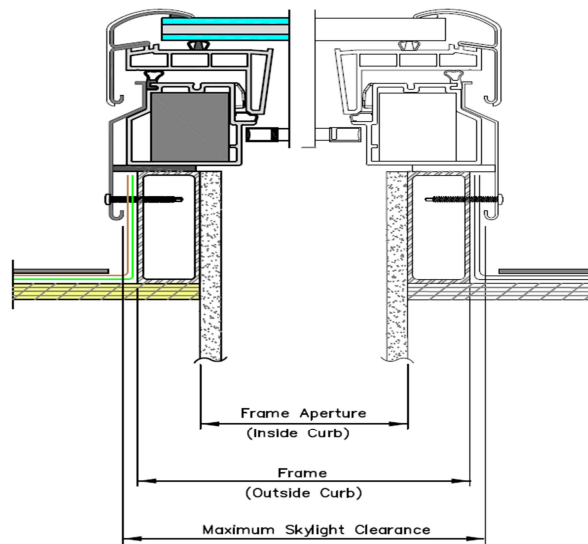

Size	Frame Width	Frame Aperture Width	Max. Skylight Clearance Width	Frame Height	Frame Aperture Height	Max. Skylight Clearance Height	Daylight Area (Sq. Feet)
2222	25 ½	22 ½	26 9/16	25 ½	22 ½	26 9/16	2.58
2234	25 ½	22 ½	26 9/16	37 ½	34 ½	38 9/16	4.20
2246	25 ½	22 ½	26 9/16	49 ½	46 ½	50 9/16	5.92
3030	33 ½	30 ½	34 9/16	33 ½	30 ½	34 9/16	5.27
3046	33 ½	30 ½	34 9/16	49 ½	46 ½	50 9/16	8.29
3434	37 ½	34 ½	38 9/16	37 ½	34 ½	38 9/16	6.89
*4622	49 ½	46 ½	50 9/16	25 ½	22 ½	26 9/16	5.92
4646	49 ½	46 ½	50 9/16	49 ½	46 ½	50 9/16	13.13

Glazings and Certification

Glazing	NFRC U-factor	NFRC SHGC	NFRC Vt	Hallmark 426-H-695	IAPMO-ES ER 199	Fla Prod Approval 13303	HVH Z	TDI
04 Laminated -2.3 mm laminated (0.76 mm interlayer) with tempered Low E366 outer pane.	0.52	0.24	0.55	√	√	√		SK-03
*06 Impact – 2.3 mm laminated (2.28 mm interlayer) with tempered Low E366 outer pane for hurricane areas	0.48	0.24	0.55	√	√	√	√	SK-14
*08 White laminated -2.3 mm Laminated (0.76mm white interlayer) with tempered Low E366 outer pane.	0.52	0.23	0.39	√	√	√		SK-03

Consult with Customer Service for special glazing options.

*VCS only

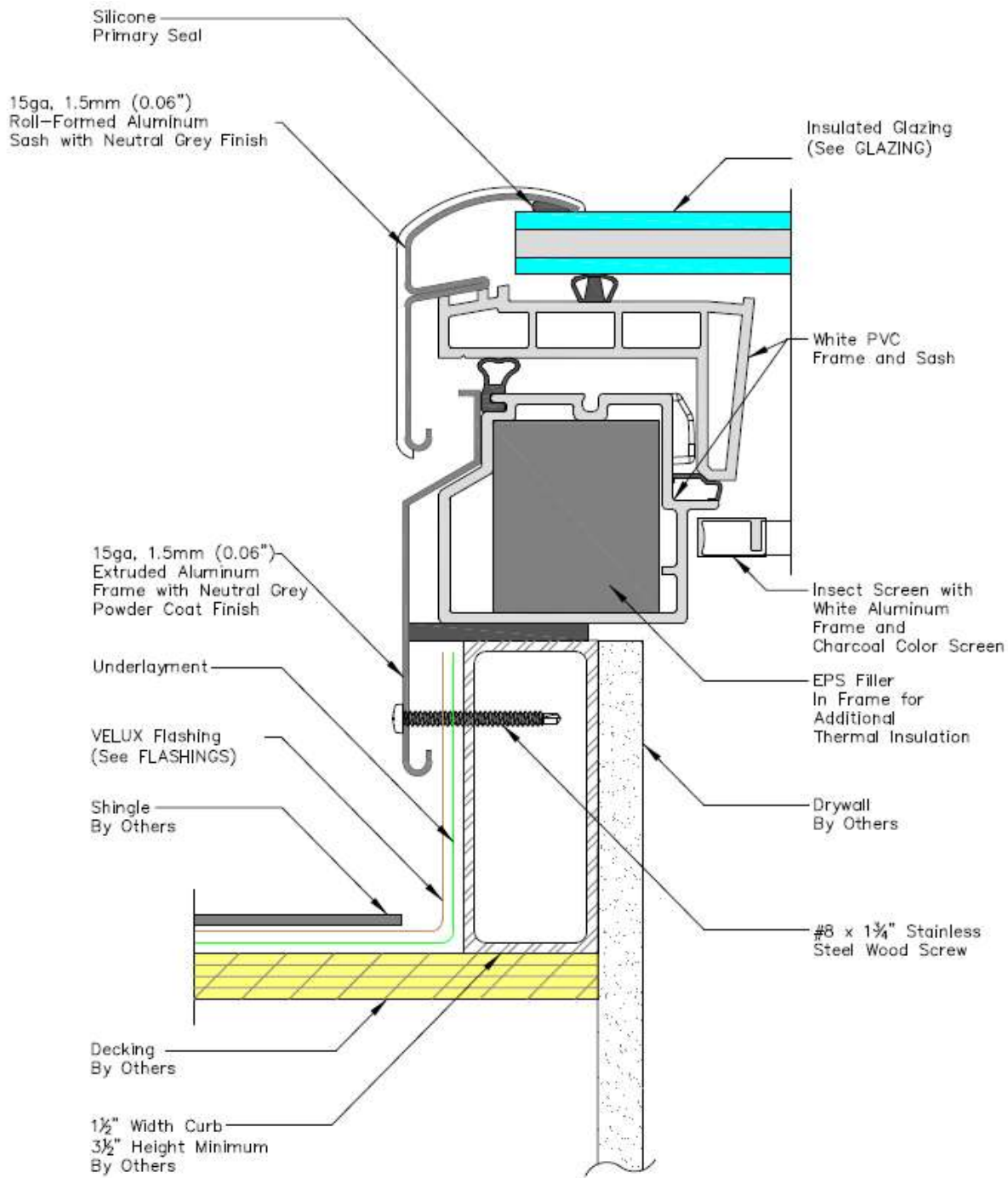

Corner keys made of ASA Luran in neutral grey finish.