

ACCESSORIES AND DETAILS

LH & DLH SERIES LONGSPAN STEEL JOISTS

STANDARD TYPES

Longspan steel joists can be furnished with either underslung or square ends, with parallel chords or with single or double pitched top chords to provide sufficient slope for roof drainage.

The Longspan joist designation is determined by its nominal depth at the center of the span, except for offset double pitched joists, where the depth should be given at the ridge. A part of the designation should be either the section number or the total design load over the design live load (TL/LL given in plf).

All pitched joists will be cambered in addition to the pitch unless specified otherwise.

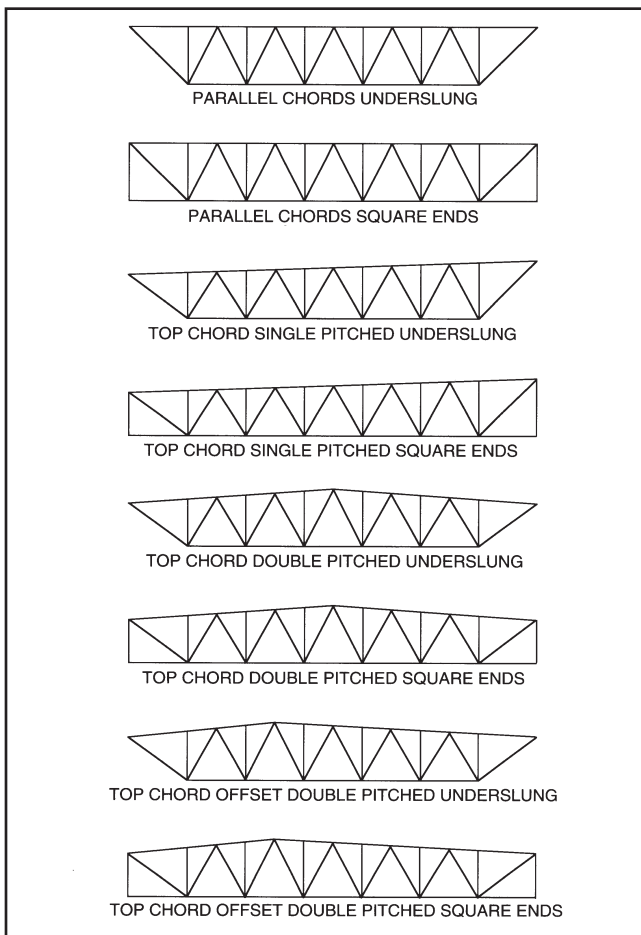

CAMBER

Non-Standard Types: The design professional shall provide on the structural drawings the amount of camber desired in inches. If camber is not specified, Vulcraft will use the camber values for LH and DLH joists based on top chord length.

Standard Types: The camber listed in the table will be fabricated into the joists unless the design professional specifically states otherwise on the structural drawings.

NON-STANDARD TYPES

The following joists can also be supplied by Vulcraft, however, **THE DISTRICT SALES OFFICE OR MANUFACTURING FACILITY NEAREST YOU SHOULD BE CONTACTED FOR ANY LIMITATIONS IN DEPTH OR LENGTH.**

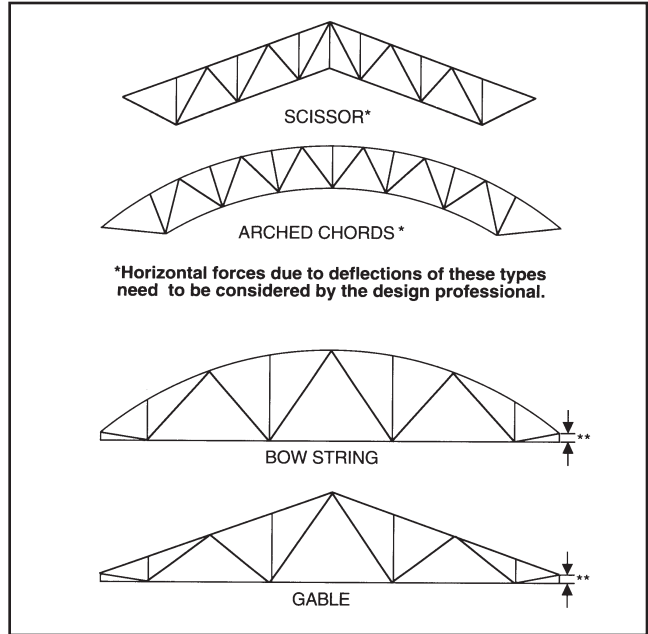

**Contact Vulcraft for minimum depth at ends.

CAMBER FOR STANDARD TYPES

LH & DLH series joists shall have camber in accordance with the following table.***

Top Chord Length	Approx. Camber
20'-0" (6096 mm)	1/4" (6 mm)
30'-0" (9144 mm)	3/8" (10 mm)
40'-0" (12192 mm)	5/8" (16 mm)
50'-0" (15240 mm)	1" (25 mm)
60'-0" (18288 mm)	1 1/2" (38 mm)
70'-0" (21336 mm)	2" (51 mm)
80'-0" (24384 mm)	2 3/4" (70 mm)
90'-0" (27432 mm)	3 1/2" (89 mm)
100'-0" (30480 mm)	4 1/4" (108 mm)
110'-0" (33528 mm)	5" (127 mm)
120'-0" (36576 mm)	6" (152 mm)
130'-0" (39621 mm)	7" (178 mm)
140'-0" (42672 mm)	8" (203 mm)
144'-0" (43890 mm)	8 1/2" (216 mm)

*** NOTE: If full camber is not desired near walls or other structural members please note on the structural drawings.