

PRODUCT SUBMITTAL

Series 800 Ladder Level-Eye (Hook & Eye)

WIRE-BOND

Flush welded to face of longitudinal wire to meet TMS 402 Code

Height of the reinforcing will not exceed half the dimension of the joint (3/8" joint = 3/16" max reinforcement).

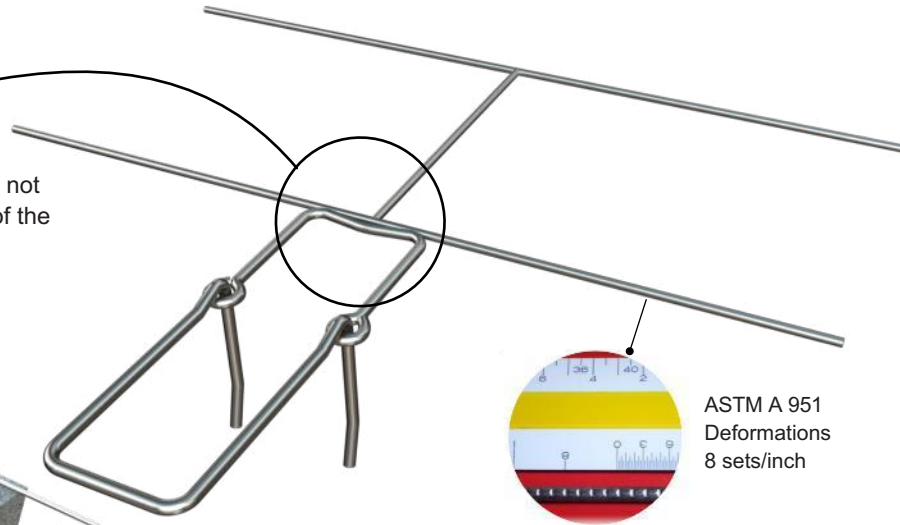
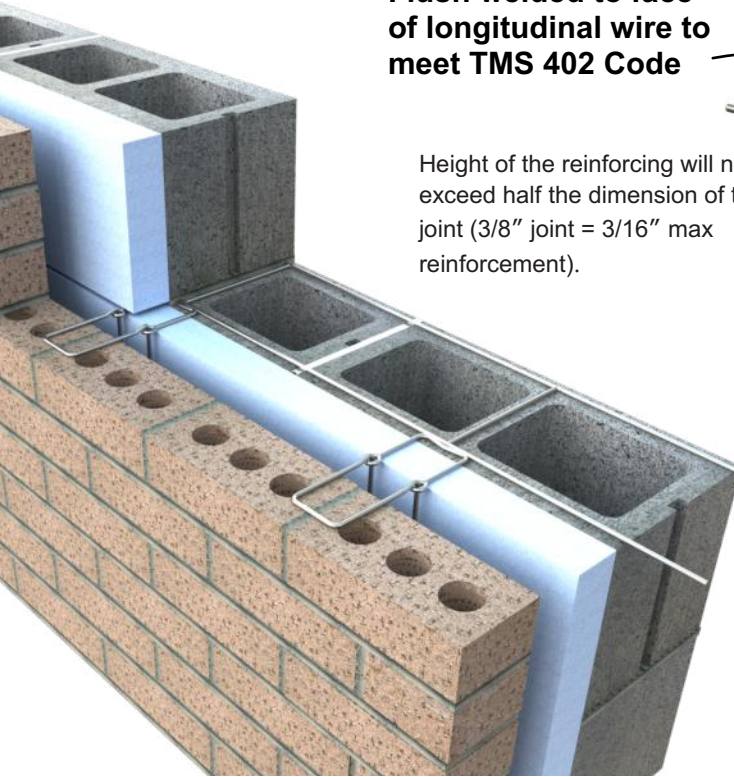

16" O.C. cross rods allow core clearance.

STRUCTURAL PERFORMANCE CHARACTERISTICS

Capable of withstanding 100 lbs load in tension and compression without deforming or developing play in excess of .05 inch.

- Double eye is butt welded to side rod 16" O.C.
- Height of double eye will not exceed 3/16" in bed joint.
- Easier to maintain 3/8" mortar joint.

MATERIAL CONFORMANCE	SIZES / FINISHES						
Wire (Carbon Steel): Prefabricated from cold-drawn steel wire conforming to ASTM A1064/A1064M	WIRE SIZE:			SIDE RODS:		CROSS RODS:	
Tensile Strength - 80,000 p.s.i. Yield Point - 70,000 p.s.i. minimum	Standard	3/16	3/16	9 Gauge (.148 in)	3/16 (.187 in)	9 Gauge	9 Gauge
ASTM A951/A951M (Standard Specification for Steel Wire for Masonry Joint Reinforcement)	Heavy Duty	3/16	3/16	9 Gauge	3/16 (.187 in)	9 Gauge	3/16
ACI / ASCE 530 (Building Code Requirements for Masonry Structures)	Extra Heavy Duty	3/16	3/16	3/16 (.187 in)	3/16 (.187 in)	3/16	3/16
Mill Galvanized coating: ASTM A641/A641M (0.1 oz/ft)	CMU SIZE:						
Hot-Dip Galvanized after fabrication: ASTM A153/A153M-B2 (1.5 oz/ft)	4"	6"	8"	10"	12"	14"	16"
Wire (Stainless Steel): ASTM A580/ASTM 580M - AISI Type 304 (Type 316 available on special orders)	Insulation:						
	0"	1"	1-1/2"	2"	2-1/2"	3"	
		3-1/2"	4"				
	PINTLE: 3/16" dia. standard						
	Length:		3-1/4"		4-1/4"	5-1/4"	Other
	FINISHES:			Hot Dip Galvanized		Stainless Steel	

** Please state overall wall size and cavity or insulation when ordering

Corporate Office: 400 Rountree Rd Charlotte, NC 28217
TEL: (800) 849-6722 FAX: (704) 525-3761

Mailing Address: P.O. Box 240988 Charlotte, NC 28224



www.wirebond.com

Memphis Plant: 2365 Harbor Ave. Memphis, TN 38113
TEL: (800) 441-8359 FAX: (901) 775-9449

Mailing Address: P.O. Box 13124 Memphis, TN 38113