



TECHNICAL BULLETIN

SECURING MEL-DRAIN™ IN VERTICAL INSTALLATIONS

During MEL-DRAIN installation in vertical and near-vertical applications, it is necessary to temporarily secure MEL-DRAIN in place prior to soil backfill or wall formation. Common attachment methods include construction adhesives, mechanical fasteners (typically using nail gun), double-sided tapes, insulation anchors, and nails through washers or wood lathing. Construction adhesives with high solvent contents should be avoided as they may damage MEL-DRAIN products. Acceptable attachment methods are dependent upon what kind of substrate MEL-DRAIN is being attached to and are discussed below.

For attaching MEL-DRAIN to concrete or wood, the most common methods are construction adhesives, double-sided tape, or mechanical fasteners.

For attaching MEL-DRAIN to soil, the most common method is the use of 4" - 8" (101.6 - 203.2 mm) long galvanized nails on approximately 4' (1.2 m) spacing. Nail length will vary depending upon the surface to which the MEL-DRAIN is being attached. Nails should have flat heads and washers or wood lathing may be used to prevent the nail head from being driven through the MEL-DRAIN.

At the top edge, take special care when installing fasteners. Use TERMINATION BAR from W. R. MEADOWS in all installations. Fasteners should only be used at the top edge of the installation. Do not use fasteners in the field of the waterproofing membrane installation below the top edge. Do not damage the waterproofing membrane under any circumstance. Any penetrations will need to be repaired. If fasteners are required to penetrate the waterproofing membrane, please see the FASTENER PENETRATION TECHNICAL BULLETIN for proper recommendations.

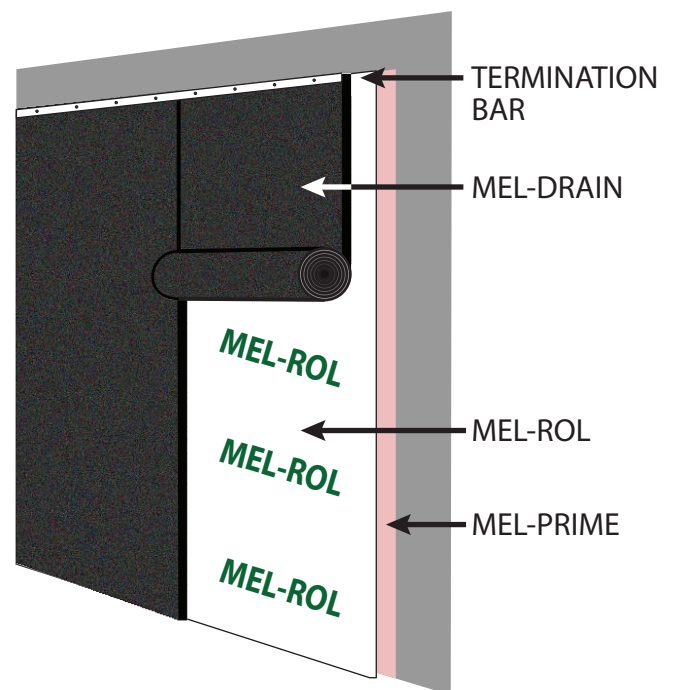

W. R. MEADOWS, INC. | P.O. Box 338 | HAMPSHIRE, IL 60140-0338
Phone: 847/214-2100 | Fax: 847/683-4544 | www.wrmeadows.com